



# Dornbracht Product program 2015 / Kitchen EXPORT

Price list –  
does not include statutory VAT

Valid from 01.04.2015



Culturing Life

# List of contents

Index	IV - V
Modifications 2015	VI
Finishes	VII
Generic miscellaneous	095 - 102
Concealed articles	103 - 108
General information	109 - 113



## Pull-down

001 - 004



## Pull-out

005 - 010



## Pivot

011 - 012



## eUnit Kitchen

013 - 018



## Water Dispenser

019 - 022

Price list – does not include statutory VAT.

Models, programmes and technical modifications  
as well as errors are excepted.

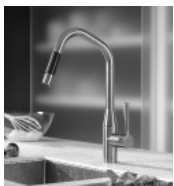

## Sync

023 - 024

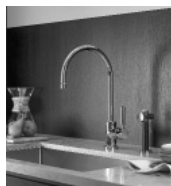

## Tara Classic

071 - 076

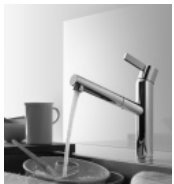

## eno

025 - 028



## Tara.

077 - 084



## Elio

029 - 034



## Water Units

085 - 094



## Tara Ultra

035 - 046



## Lot

047 - 056



## Maro

057 - 060

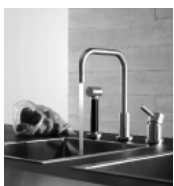

## Meta.02

061 - 070

# Index

Art. No.	Euro	Page	Art. No.	Euro	Page	Art. No.	Euro	Page
04			27 780 970-00	817,60	102	33 826 876-00	514,50	039, 040
04 31 20 067 00-86	24,50	102	-06	1.226,40	102	-06	771,80	039, 040
10			27 784 970-00	944,50	101	33 826 888-00	570,10	073, 074
10 710 970-00	129,20	096	-06	1.417,10	101	-06	855,00	073, 074
-06	193,70	096	27 789 970-00	891,60	101	-49	1.140,10	073
-49	258,30	096	-06	1.337,20	101	33 840 760-00	443,30	007, 027
10 711 970-00	129,20	096	30			-06	576,50	007, 027
-06	193,70	096	30 151 892-00	381,70	082	33 840 790-00	558,30	009, 031
10 712 970-00	129,20	096	-06	572,60	082	-06	725,70	009, 031
-06	193,70	096	30 800 875-00	689,40	045	33 845 760-00	492,30	006, 026
10 713 970-00	91,10	097	-06	1.034,00	045	-06	640,00	006, 026
-06	136,60	097	31			33 845 875-00	923,30	012, 044
-49	182,20	097	31 151 892-00	738,40	082	-06	1.384,90	012, 044
10 714 970-00	91,10	098	-06	1.107,50	082	-49	1.846,60	012, 044
-06	136,60	098	32			33 850 875-00	547,90	037
10 730 970-00	579,60	097	32 800 625-00	591,50	063	-06	821,60	037
-06	631,50	097	-06	886,90	063	33 855 888-00	658,40	073
10 731 970-00	579,60	097	32 800 680-00	1.190,40	048	-06	987,80	073
-06	631,50	097	-06	1.785,60	048	33 860 875-00	1.015,30	043
12			32 800 790-00	614,10	033	-06	1.523,00	043
12 070 970 90	142,20	105	-06	798,30	033	33 870 760-00	472,40	007, 027
12 071 970-00	160,90	105	32 800 795-00	965,40	059	-06	614,10	007, 027
-06	286,30	105	-06	1.448,30	059	33 870 790-00	587,30	008, 030
12 650 970-00	266,50	067, 068, 069	32 805 680-00	931,20	053	-06	763,40	008, 030
-06	426,30	067, 068, 069	-06	1.397,20	053	33 870 791-00	685,00	008, 030
12 715 970-00	28,80	102	32 812 680-00	1.100,50	049	-06	890,40	008, 030
-06	46,10	102	-06	1.650,70	049	33 870 875-00	587,30	003, 042
12 892 970 90	782,00	020, 021, 022, 041, 054	32 815 625-00	656,40	065	-06	763,30	003, 042
12 895 970 90	89,50	022	-06	984,50	065	33 870 895-00	648,90	002, 024
12 896 970 90	89,40	022	32 835 680-00	1.130,90	052	-06	843,60	002, 024
12 995 970 90	68,00	102	-06	1.696,50	052	33 875 760-00	521,30	006, 026
17			32 835 875-00	1.064,10	043	-06	677,70	006, 026
17 800 875-00	732,00	044	-06	1.596,30	043	33 875 895-00	648,90	002, 024
-06	1.098,20	044	32 843 680-00	1.190,40	051	-06	843,60	002, 024
17 861 680-00	999,20	021, 054	-06	1.785,60	051	33 880 888-00	1.205,10	074
-06	1.498,90	021, 054	33			-06	1.807,50	074
17 861 875-00	614,70	020, 041	33 800 760-00	390,80	028	33 880 889-00	1.205,10	075
-06	922,00	020, 041	-06	508,00	028	-06	1.807,50	075
19			33 800 790-00	528,20	032	33 890 790-00	685,00	009, 031
19 815 892-00	714,10	078	-06	686,70	032	-06	890,40	009, 031
-06	1.071,60	078	33 800 795-00	816,10	058	35		
20			-06	1.223,70	058	35 086 970 90	82,80	104
20 815 882-00	834,90	080	33 800 875-00	476,50	036	35 707 970 90	223,30	106
-06	1.252,60	080	-06	714,70	036	35 712 970 90	197,10	107
20 815 892-00	765,20	079	33 800 888-00	580,80	072	35 713 970 90	223,30	106
-06	1.148,00	079	-06	871,10	072	35 714 970 90	223,30	107
-49	1.530,60	079	33 805 875-00	463,80	042	35 806 970 90	225,40	104
22			-06	695,60	042	35 807 970 90	225,40	104
22 815 892-00	407,90	078	33 810 625-00	531,30	062	35 808 970 90	225,40	105
-06	611,80	078	-06	797,00	062	35 816 970 90	257,90	106
-49	815,80	078	33 815 888-00	580,80	072	36		
27			-06	871,10	072	36 818 892-00	852,90	083
27 714 970-00	396,10	100	-49	1.161,60	072	-06	1.279,40	083
-06	594,20	100	33 816 875-00	489,00	036	-49	1.705,80	083
27 718 970-00	381,90	101	-06	733,70	036	36 819 892-00	865,80	084
-06	572,80	101	33 816 876-00	501,80	037	-06	1.298,40	084
-49	763,80	101	-06	752,80	037	36 820 680-00	796,80	056
27 719 970-00	365,20	100	33 818 875-00	501,80	038	-06	1.195,40	056
-06	547,90	100	-06	752,80	038	36 834 625-00	666,50	067
			33 820 625-00	531,30	062, 063	-06	999,70	067
			-06	797,00	062, 063	36 838 625-00	708,90	068
			33 826 790-00	528,20	032, 033	-06	1.063,60	068
			-06	686,70	032, 033	36 851 625-00	722,00	069
			33 826 795-00	870,00	058, 059	-06	1.083,00	069
			-06	1.305,10	058, 059			
			33 826 875-00	501,80	038, 039			
			-06	752,80	038, 039			

# Index

Art. No.	Euro	Page	Art. No.	Euro	Page
<b>37</b>			<b>84</b>		
<b>37 847 875-00</b>	1.251,70	045	<b>84 700 000-13</b>	218,40	086, 087, 088, 089, 090, 091, 092, 093, 094
<b>-06</b>	1.877,60	045	<b>-48</b>	328,70	086, 087, 088, 089, 090, 091, 092, 093, 094
<b>37 849 680-00</b>	1.386,00	055			
<b>-06</b>	2.079,10	055	<b>84 710 000-13</b>	148,50	020, 021, 041, 054, 089, 102
<b>38</b>			<b>84 750 000-13</b>	166,40	086, 088, 089, 094
<b>38 000 000-86</b>	1.119,00	089	<b>-48</b>	219,50	086, 088, 089, 094
<b>38 001 000-86</b>	1.346,10	020, 021, 041, 054, 089	<b>84 751 000-13</b>	125,70	086, 088, 089, 094
<b>38 030 000-86</b>	1.182,10	089	<b>-48</b>	183,00	086, 088, 089, 094
<b>38 031 000-86</b>	1.417,60	089			
<b>38 040 000-86</b>	1.232,50	090			
<b>38 041 000-86</b>	1.479,90	090			
<b>38 050 000-86</b>	1.304,60	090			
<b>38 051 000-86</b>	1.572,60	090			
<b>38 060 000-86</b>	1.325,80	091			
<b>38 061 000-86</b>	1.494,80	091			
<b>38 080 000-86</b>	1.452,50	091			
<b>38 081 000-86</b>	1.630,70	091			
<b>38 090 000-86</b>	1.480,90	092			
<b>38 091 000-86</b>	1.657,70	092			
<b>38 100 000-86</b>	1.544,50	092			
<b>38 101 000-86</b>	1.721,30	092			
<b>38 111 000-86</b>	1.739,10	093			
<b>38 401 000-86</b>	2.657,40	093			
<b>38 511 000-86</b>	3.030,10	086			
<b>38 521 000-86</b>	3.749,60	086			
<b>38 531 000-86</b>	3.521,30	087			
<b>38 541 000-86</b>	3.602,50	087			
<b>38 561 000-86</b>	2.660,30	088			
<b>38 571 000-86</b>	3.107,60	088			
<b>41</b>					
<b>41 270 680-00</b>	4.149,60	015			
<b>-06</b>	4.894,40	015			
<b>41 270 790-00</b>	3.830,40	016			
<b>-06</b>	4.575,20	016			
<b>41 270 875-00</b>	4.149,60	017			
<b>-06</b>	4.894,40	017			
<b>41 271 875-06</b>	7.660,70	014			
<b>42</b>					
<b>42 761 979-00</b>	587,20	014, 015, 016, 017			
<b>-06</b>	939,60	014, 015, 016, 017			
<b>82</b>					
<b>82 426 970-00</b>	183,40	099			
<b>-06</b>	275,10	099			
<b>82 427 970-00</b>	266,20	098			
<b>-06</b>	399,30	098			
<b>82 435 970-00</b>	148,50	100			
<b>-06</b>	222,90	100			
<b>82 436 970-00</b>	199,80	099			
<b>-06</b>	299,60	099			
<b>-49</b>	399,50	099			
<b>82 437 970-00</b>	308,60	098			
<b>-06</b>	462,80	098			
<b>82 438 970-00</b>	228,50	099			
<b>-06</b>	342,50	099			

# Modifications 2015

---

## Supplements

**Sync** The new SYNC series includes two pull-down single-lever mixers with spray function, 33 875 895-FF and 33 870 895-FF. The new, dynamic, front-facing design language literally comes towards the user, making work easy and ergonomic. Distinctive for SYNC is the conical transition between the body and the spout, and parallel to it, the inner contour of a lever that has no bevelled edges (available second quarter of 2015).

**eno** The pull-out single-lever mixer 33 845 760-FF and the pull-out single-lever mixer with spray function 33 875 760-FF are added to the ENO series (available second quarter of 2015).

**Tara Ultra** The pull-down single-lever mixer with spray function 33 870 875-FF is added to the TARA ULTRA series (available second quarter of 2015).

**Meta.02** Single-lever mixer 33 810 625-FF and single-lever mixer 33 820 625-FF are added to the series, for combining with side-mounted rinsing spray and profi spray sets (available immediately).

## Discontinuations

The following products will be discontinued from the product programme on 30.09.2015:

**Meta.02** Single-mixer 33 800 625-FF and single-mixer 33 826 625-FF for combining with side-mounted rinsing spray and profi spray sets are withdrawn from the product range.

## Cyprum

The following products are available in our special and exclusive CYPRUM finish:

	Article number	Name
Pivot	33 845 875-49	Single-lever mixer
Tara Classic	33 815 888-49	Single-lever mixer
	33 826 888-49 + 27 718 970-49	Single-lever mixer with rinsing spray set
Tara.	22 815 892-49	Single-hole mixer
	20 815 892-49	Three-hole mixer with rinsing spray set
	20 815 892-49 + 27 718 970-49	Three-hole mixer with rinsing spray set
	36 818 892-49	Wall-mounted sink mixer
Miscellaneous	10 710 970-49	Strainer waste with control handle
	10 713 970-49	AIR SWITCH (control button)
	82 436 970-49	Integrated washing-up liquid dispenser with rosette

All Professional Information can also be found at [www.dornbracht.com](http://www.dornbracht.com).

## Descriptions of the finishes

Dornbracht products are designed to retain their special aesthetic quality and reliability over many years. This is why we attach great importance to maintaining a high standard of quality throughout the production process. This starts with selecting the right raw materials. Then the pieces are formed and polished. After numerous further stages and strict quality controls, the fittings are given their exquisite finishes in the electroplating shop. They then undergo a further check and are carefully packed, so that our exclusive, hand-made products can be safely transported.

The list below contains technical information about our surface finishes.

Finish	Description	Production
Polished chrome	The classically elegant, high-gloss finish	1. Base material (brass) 2. Surface work: rough grinding and regrinding, polishing, superfine polishing 3. Preparatory treatment: cleaning, ultrasonic cleaning 4. First plated coating: shiny nickel 5. Second plated coating: chrome
Platinum matt	A warm tone, with an elegant, matt finish	1. Base material (brass) 2. Surface work: rough grinding and regrinding, polishing, matt finishing 3. Preparatory treatment: cleaning, ultrasonic cleaning 4. First plated coating: matt nickel 5. Second plated coating: palladium nickel
Cyprum	A warm rose gold colour with a high-gloss, many-facetted finish	1. Base material (brass) 2. Surface work: rough grinding and regrinding, polishing, superfine polishing 3. Preparatory treatment: cleaning, ultrasonic cleaning 4. First plated coating: shiny nickel 5. Second plated coating: palladium nickel 6. Third plated coating: 18-carat gold



# Pull-down

Sieger Design



The pull-down single-lever mixer features a functional element that can be extended downward. At the touch of a button, it changes from a gentle laminar flow with minimal splashing to a powerful spray jet.

All Professional Information can also be found at [www.dornbracht.com](http://www.dornbracht.com).

33 875 895

Sync



**Single-lever mixer Pull-down with spray function**

- 240 mm projection
- pivotable spout 360°
- optional limiting, pivoting 150°
- hole diameter 35 mm
- Laminar and spray flow
- cartridge with ceramic discs
- 2x pressure hose M 8 x 1 x 600 mm
- 1500 mm metal shower hose
- sprayface with anti-scaling system
- Max. flow 10 l/min at 3 bar flow pressure
- lead-free

Intrinsic protection against back flow.

Available for delivery from the second quarter of 2015

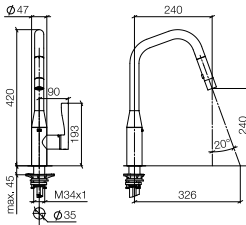

		Euro
polished chrome	33 875 895-00	648,90
platinum matt	33 875 895-06	843,60

33 870 895

Sync



**Single-lever mixer Pull-down with spray function**

- 240 mm projection
- pivotable spout 360°
- optional limiting, pivoting 150°
- hole diameter 35 mm
- Laminar and spray flow
- cartridge with ceramic discs
- 2x pressure hose M 8 x 1 x 600 mm
- 1500 mm metal shower hose
- sprayface with anti-scaling system
- Max. flow 10 l/min at 3 bar flow pressure
- lead-free

Intrinsic protection against back flow.

Available for delivery from the second quarter of 2015

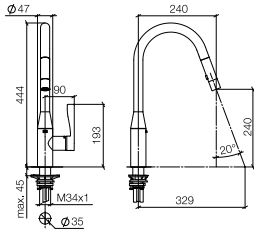

		Euro
polished chrome	33 870 895-00	648,90
platinum matt	33 870 895-06	843,60

33 870 875

Tara Ultra

**Single-lever mixer Pull-down with spray function**

- 240 mm projection
- pivotable spout 360°
- optional limiting, pivoting 150°
- hole diameter 35 mm
- Laminar and spray flow
- cartridge with ceramic discs
- 2x pressure hose M 8 x 1 x 600 mm
- 1500 mm metal shower hose
- sprayface with anti-scaling system
- Max. flow 10 l/min at 3 bar flow pressure
- lead-free

Intrinsic protection against back flow.

Available for delivery from the second quarter of 2015

		Euro
polished chrome	33 870 875-00	587,30
platinum matt	33 870 875-06	763,30

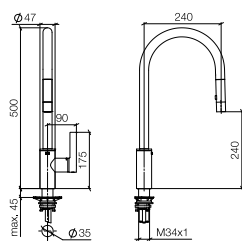



# Pull-out

Sieger Design



The pull-out single-lever mixer features a functional element that can be extended forwards and can be ordered with an extending spout or extending spray, as required.

All Professional Information can also be found at [www.dornbracht.com](http://www.dornbracht.com).

33 875 760

eno

**Single-lever mixer Pull-out with spray function**

- 225 mm projection
- pivotable spout 130°
- hole diameter 35 mm
- cartridge with ceramic discs
- 2x pressure hose M 8 x 1 x 600 mm
- 1600 mm metal shower hose
- Max. flow 8 l/min at 3 bar flow pressure
- lead-free

Available for delivery from the second quarter of 2015

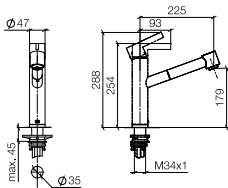

		Euro
polished chrome	33 875 760-00	521,30
platinum matt	33 875 760-06	677,70

33 845 760

eno

**Single-lever mixer Pull-out**

- 220 mm projection
- pivotable spout 130°
- hole diameter 35 mm
- cartridge with ceramic discs
- 2x pressure hose M 8 x 1 x 600 mm
- 1600 mm metal shower hose
- Max. flow 10 l/min at 3 bar flow pressure
- lead-free

Available for delivery from the second quarter of 2015

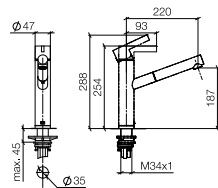

		Euro
polished chrome	33 845 760-00	492,30
platinum matt	33 845 760-06	640,00

33 870 760

eno

Single-lever mixer Pull-out with spray function

- 225 mm projection
- pivotable spout 130°
- hole diameter 35 mm
- cartridge with ceramic discs
- 3x M 10 x 1 x 420 mm high pressure hose
- fabric braided hose 1500 mm
- Max. flow 7 l/min at 3 bar flow pressure
- lead-free

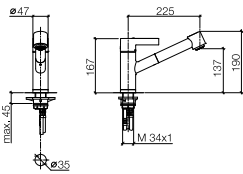

		Euro
polished chrome	33 870 760-00	472,40
platinum matt	33 870 760-06	614,10

33 840 760

eno

Single-lever mixer Pull-out

- 220 mm projection
- pivotable spout 130°
- hole diameter 35 mm
- cartridge with ceramic discs
- 3x M 10 x 1 x 420 mm high pressure hose
- fabric braided hose 1500 mm
- Max. flow 8 l/min at 3 bar flow pressure
- lead-free

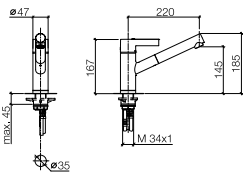

		Euro
polished chrome	33 840 760-00	443,30
platinum matt	33 840 760-06	576,50

33 870 790

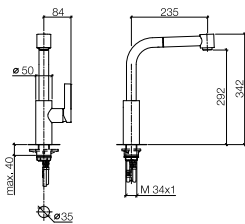

Elio

**Single-lever mixer Pull-out with spray function**

- 235 mm projection
- pivotable spout 360°
- hole diameter 35 mm
- cartridge with ceramic discs
- 3x M 10 x 1 x 420 mm high pressure hose
- fabric braided hose 1500 mm
- Max. flow 7 l/min at 3 bar flow pressure
- lead-free

		Euro
polished chrome	33 870 790-00	587,30
platinum matt	33 870 790-06	763,40

33 870 791

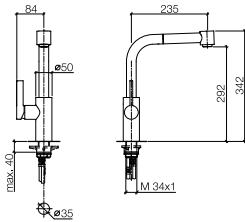

Elio

**Single-lever mixer Pull-out with spray function, with lever on left**

- 235 mm projection
- pivotable spout 360°
- hole diameter 35 mm
- cartridge with ceramic discs
- 3x M 10 x 1 x 420 mm high pressure hose
- fabric braided hose 1500 mm
- Max. flow 7 l/min at 3 bar flow pressure
- lead-free

		Euro
polished chrome	33 870 791-00	685,00
platinum matt	33 870 791-06	890,40

33 890 790

Elio

**Single-lever mixer Pull-out with spray function, for open hot-water boilers (low pressure)**

- 235 mm projection
- pivotable spout 360°
- hole diameter 35 mm
- cartridge with ceramic discs
- 2x M 10 x 3/8" x 500 mm high pressure hose
- 1x M 10 x 1 x 420 mm high pressure hose
- fabric braided hose 1500 mm
- Max. flow 7 l/min at 3 bar flow pressure
- lead-free

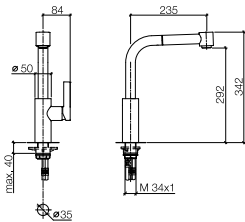

		Euro
polished chrome	33 890 790-00	685,00
platinum matt	33 890 790-06	890,40

33 840 790

Elio

**Single-lever mixer Pull-out**

- 235 mm projection
- pivotable spout 360°
- hole diameter 35 mm
- cartridge with ceramic discs
- 3x M 10 x 1 mm x 420 mm high pressure hose
- fabric braided hose 1500 mm
- Max. flow 8 l/min at 3 bar flow pressure
- lead-free

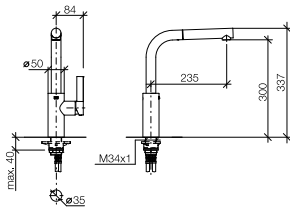

		Euro
polished chrome	33 840 790-00	558,30
platinum matt	33 840 790-06	725,70



# Pivot

Sieger Design



PIVOT combines high-quality aesthetics with practical functionality. It is the first fitting for use on the complete kitchen island – with a radius of action of 360°, the individual areas of application in the kitchen can be effortlessly combined.

All Professional Information can also be found at [www.dornbracht.com](http://www.dornbracht.com).

33 845 875

Tara Ultra

PIVOT, single-lever mixer

- 552 mm projection
- pivotable spout 360°
- hole diameter 35 mm
- cartridge with ceramic discs
- 2x pressure hose M 8 x 1 x 600 mm
- Max. flow 8 l/min at 3 bar flow pressure
- lead-free

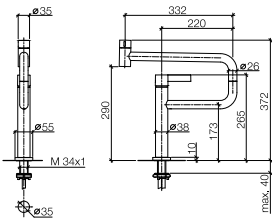

		Euro
polished chrome	33 845 875-00	923,30
platinum matt	33 845 875-06	1.384,90
cyprum	33 845 875-49	1.846,60

# eUnit Kitchen

Sieger Design



The first electronic product solution for the kitchen from Dornbracht: the different functions of eUNIT KITCHEN help you with your everyday work in the kitchen. The control elements give you accurate control of water temperature and volume and the foot sensor takes the place of a "missing" free hand, allowing water to flow without you having to lift a finger. Added to this are the electronic strainer waste and a water dispensing function that allows water to be dispensed in precise amounts of 1 litre and 0.1 litre steps.

All Professional Information can also be found at [www.dornbracht.com](http://www.dornbracht.com).

41 271 875

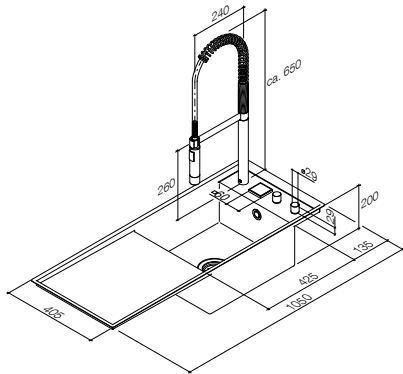

**eUNIT KITCHEN, electronic functional unit,  
integrated into the sink**

**TARA ULTRA Profi outlet**

- Spout, projection 240 mm
- pivotable spout 360°
- Laminar and spray flow
- Max. flow 8 l/min at 3 bar flow pressure
- Intrinsic protection against back flow
- lead-free

**Single sink, 1100 mm x 405 mm**

- Single sink with drainer and lowered tap hole bank
- Sink depth 200 mm
- Stainless steel, material thickness 1.5 mm
- Installation, on top or flush
- Complete pop-up waste and overflow set with valve bridge
- 3 1/2" closable strainer basket valve
- mounting kit

**Electronic strainer waste**

- to automatically open and close the 3 1/2" strainer basket valve

**Foot sensor**

- for starting and stopping the flow of water, contact-free
- Class 1 laser product (meets the requirements of DIN EN 60825-1/IEC 60825-1:2007)
- Holder for attachment

**Electronic control elements, pre-fitted  
(SMART TOOLS)**

- 2 x twist-action control elements with electronic control for temperature and volume
- 1 x display switch control element with electronic control for a TARA ULTRA Profi outlet, electronic strainer waste and dosing function, 60 x 60 mm
- preset temperature and volume
- Button lock for cleaning
- Pause function
- Service displays
- can be updated and networked
- App for individualisation

**Control unit and connection materials**

- ready-to-use control unit for wall mounting incl. 1 x eVALVE electronic valve for water temperature and volume adjustment, (240 mm x 135 mm x 60 mm)
- 2x 1/2"IG x 1/2"IG x 400 mm high pressure hose
- 100-240 V AC / 12 V DC, 50-60 Hz, 18 W power supply unit, incl. country-specific adapter set
- 2x angle valve with filter

**Technical data**

- Minimum flow pressure 2.5 bar
- Max. flow pressure 4 bar
- Voltage supply 100 - 240 V AC / 12 V DC

**Planning information**

- Customer must provide an earth leakage circuit breaker
- Earthing cable provided by customer

ATTENTION: Separate terms and conditions for electronic articles are applicable.

All Professional Information and detailed planning information can be found at [www.dornbracht.com](http://www.dornbracht.com)

		Euro
platinum matt	41 271 875-06	7.660,70



**Optional miscellaneous**

**Setting display switch**

- 1 x display switch control element with electronic control 60 x 60 mm
- 1x concealed box for fitting into the pre-wall installation or in the bath rim, hole diameter 56 mm, recess depth 75 mm
- for controlling up to 4 individual profiles

		Euro
polished chrome	42 761 979-00	587,20
platinum matt	42 761 979-06	939,60

A modern, minimalist kitchen sink with a tall, vertical faucet and two side handles, set against a plain background.

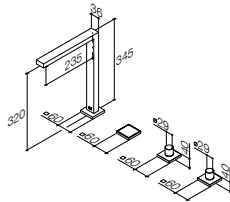

LOT outlet

- ## Electronic strainer waste

- Foot sensor

- ### Electronic control elements (SMART TOOLS)

- ### Control unit and connection materials

- ## Technical data

- ### Planning information

- All Professional Information and detailed planning information can be found at [www.dornbracht.com](http://www.dornbracht.com)

		Euro
polished chrome	41 270 680-00	4.149,60
platinum matt	41 270 680-06	4.894,40

Optional miscellaneous			Euro
<b>Setting display switch</b>	polished chrome	<b>42 761 979-00</b>	<b>587,20</b>
<ul style="list-style-type: none"> <li>• 1 x display switch control element with electronic control 60 x 60 mm</li> <li>• 1x concealed box for fitting into the pre-wall installation or in the bath rim, hole diameter 56 mm, recess depth 75 mm</li> <li>• for controlling up to 4 individual profiles</li> </ul>	platinum matt	<b>42 761 979-06</b>	<b>939,60</b>

41 270 790

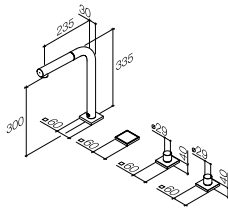

**eUNIT KITCHEN, electronic functional unit**

**ELIO outlet**

- extending spout, projection 235 mm
- pivotable spout 360°
- hole diameter spout 35 mm
- Laminar flow
- fabric braided hose 1500 mm
- Max. flow 8 l/min at 3 bar flow pressure
- lead-free

**Electronic strainer waste**

- to automatically open and close the 3 1/2" strainer basket valve

**Foot sensor**

- for starting and stopping the flow of water, contact-free
- Class 1 laser product (meets the requirements of DIN EN 60825-1/IEC 60825-1:2007)
- Holder for attachment

**Electronic control elements (SMART TOOLS)**

- 2 x twist-action control elements with electronic control for temperature and volume, each 60 x 60 mm
- 1 x display switch control element with electronic control for an ELIO outlet, electronic strainer waste and dosing function, 60 x 60 mm
- Hole diameter for each control element 35 mm
- preset temperature and volume
- Button lock for cleaning
- Pause function
- Service displays
- can be updated and networked
- App for individualisation

**Control unit and connection materials**

- ready-to-use control unit for wall mounting incl. 1 x eVALVE electronic valve for water temperature and volume adjustment, (240 mm x 135 mm x 60 mm)
- 2x 1/2"IG x 1/2"IG x 400 mm high pressure hose
- 100-240 V AC / 12 V DC, 50-60 Hz, 18 W power supply unit, incl. country-specific adapter set
- 2x angle valve with filter

**Technical data**

- Minimum flow pressure 2.5 bar
- Max. flow pressure 4 bar
- Voltage supply 100 - 240 V AC / 12 V DC

**Planning information**

- Customer must provide an earth leakage circuit breaker
- Earthing cable provided by customer

ATTENTION: Separate terms and conditions for electronic articles are applicable.

All Professional Information and detailed planning information can be found at [www.dornbracht.com](http://www.dornbracht.com)

		Euro
polished chrome	41 270 790-00	3.830,40
platinum matt	41 270 790-06	4.575,20



**Optional miscellaneous**

**Setting display switch**

- 1 x display switch control element with electronic control 60 x 60 mm
- 1x concealed box for fitting into the pre-wall installation or in the bath rim, hole diameter 56 mm, recess depth 75 mm
- for controlling up to 4 individual profiles

		Euro
polished chrome	42 761 979-00	587,20
platinum matt	42 761 979-06	939,60

41 270 875

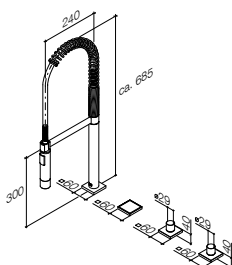
**eUNIT KITCHEN, electronic functional unit****TARA ULTRA Profi outlet**

- Spout, projection 240 mm
- pivotable spout 360°
- hole diameter spout 30 mm
- Laminar and spray flow
- Max. flow 8 l/min at 3 bar flow pressure
- Intrinsic protection against back flow
- lead-free

**Electronic strainer waste**

- to automatically open and close the 3 1/2" strainer basket valve

**Foot sensor**

- for starting and stopping the flow of water, contact-free
- Class 1 laser product (meets the requirements of DIN EN 60825-1/IEC 60825-1:2007)
- Holder for attachment

**Electronic control elements (SMART TOOLS)**

- 2 x twist-action control elements with electronic control for temperature and volume, each 60 x 60 mm
- 1 x display switch control element with electronic control for a TARA ULTRA Profi outlet, electronic strainer waste and dosing function, 60 x 60 mm
- Hole diameter for each control element 35 mm
- preset temperature and volume
- Button lock for cleaning
- Pause function
- Service displays
- can be updated and networked
- App for individualisation

**Control unit and connection materials**

- ready-to-use control unit for wall mounting incl. 1 x eVALVE electronic valve for water temperature and volume adjustment, (240 mm x 135 mm x 60 mm)
- 2x 1/2"IG x 1/2"IG x 400 mm high pressure hose
- 100-240 V AC / 12 V DC, 50-60 Hz, 18 W power supply unit, incl. country-specific adapter set
- 2x angle valve with filter

**Technical data**

- Minimum flow pressure 2.5 bar
- Max. flow pressure 4 bar
- Voltage supply 100 - 240 V AC / 12 V DC

**Planning information**

- Customer must provide an earth leakage circuit breaker
- Earthing cable provided by customer

ATTENTION: Separate terms and conditions for electronic articles are applicable.

All Professional Information and detailed planning information can be found at [www.dornbracht.com](http://www.dornbracht.com)

		Euro
polished chrome	41 270 875-00	4.149,60
platinum matt	41 270 875-06	4.894,40

**Optional miscellaneous****Setting display switch**

- 1 x display switch control element with electronic control 60 x 60 mm
- 1x concealed box for fitting into the pre-wall installation or in the bath rim, hole diameter 56 mm, recess depth 75 mm
- for controlling up to 4 individual profiles

		Euro
polished chrome	42 761 979-00	587,20
platinum matt	42 761 979-06	939,60



# Water Dispenser

Sieger Design



WATER DISPENSERS supply just filtered, cold or boiling hot water, combining sensible, practical functions with extreme ease of use in the design language of the TARA ULTRA and LOT series.

All Professional Information can also be found at [www.dornbracht.com](http://www.dornbracht.com).

17 861 875

Tara Ultra

**HOT & COLD WATER DISPENSER**

- **145 mm projection**
- rigid, thermally insulated spout
- hole diameter 35 mm
- Provides filtered, hot water up to 93°C
- Provides filtered, cold water
- Max. flow 2 l/min at 3 bar flow pressure
- ready-to-use control unit for wall mounting (135 mm x 160 mm x 60 mm)
- electronic magnetic valve
- 100-230 V, 50-60 Hz, 18 W power supply unit, incl. country-specific adapter set
- lead-free

A minimum flow pressure of 3 bar is necessary for the HOT & COLD WATER DISPENSER to work perfectly in conjunction with a hot water tank and filter.

The filter cartridge must be changed every six months. The installation instructions contain further information for guidance.

All Professional Information and detailed planning information can be found at [www.dornbracht.com](http://www.dornbracht.com)

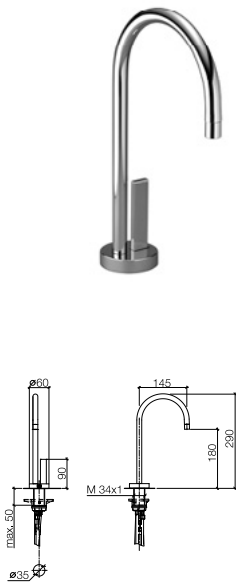

		Euro
polished chrome	17 861 875-00	614,70
platinum matt	17 861 875-06	922,00

Required miscellaneous		Euro
 <b>Hot water tank incl. filter</b>	12 892 970 90	782,00
For details see page 022		

Optional miscellaneous		Euro
 <b>Single sink 210 mm x 405 mm</b>	matt high-grade steel	38 001 000-86
Installation, on top or flush		1.346,10
For details see page 089		

Optional miscellaneous		Euro
 <b>DRINKING PLATE</b>	black	84 710 000-13
• for placing in the single sink		148,50
For details see page 108		

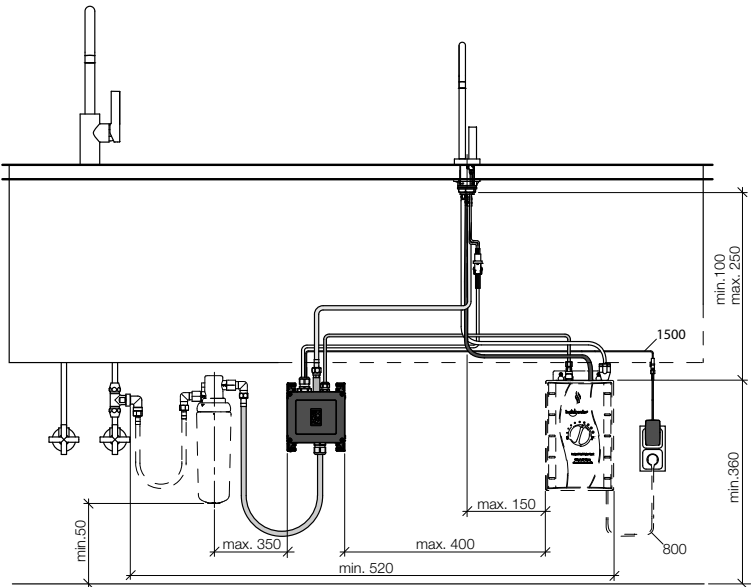

mm

17 861 680

Lot

**HOT & COLD WATER DISPENSER**

Euro

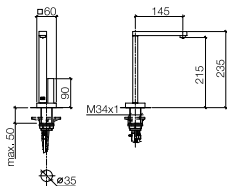

- **145 mm projection**
- rigid, thermally insulated spout
- hole diameter 35 mm
- Provides filtered, hot water up to 93°C
- Provides filtered, cold water
- Max. flow 2 l/min at 3 bar flow pressure
- ready-to-use control unit for wall mounting (135 mm x 160 mm x 60 mm)
- electronic magnetic valve
- 100-230 V, 50-60 Hz, 18 W power supply unit, incl. country-specific adapter set
- lead-free

A minimum flow pressure of 3 bar is necessary for the HOT & COLD WATER DISPENSER to work perfectly in conjunction with a hot water tank and filter.

The filter cartridge must be changed every six months. The installation instructions contain further information for guidance.

All Professional Information and detailed planning information can be found at [www.dornbracht.com](http://www.dornbracht.com)

polished chrome	<b>17 861 680-00</b>	<b>999,20</b>
platinum matt	<b>17 861 680-06</b>	<b>1.498,90</b>



Required miscellaneous

Euro

**Hot water tank incl. filter**

**12 892 970 90**

**782,00**

For details see page 022



Optional miscellaneous

Euro

**Single sink 210 mm x 405 mm**

matt high-grade steel

**38 001 000-86**

**1.346,10**

Installation, on top or flush

For details see page 089

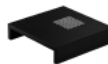

Optional miscellaneous

Euro

**DRINKING PLATE**

black

**84 710 000-13**

**148,50**

- for placing in the single sink

For details see page 108

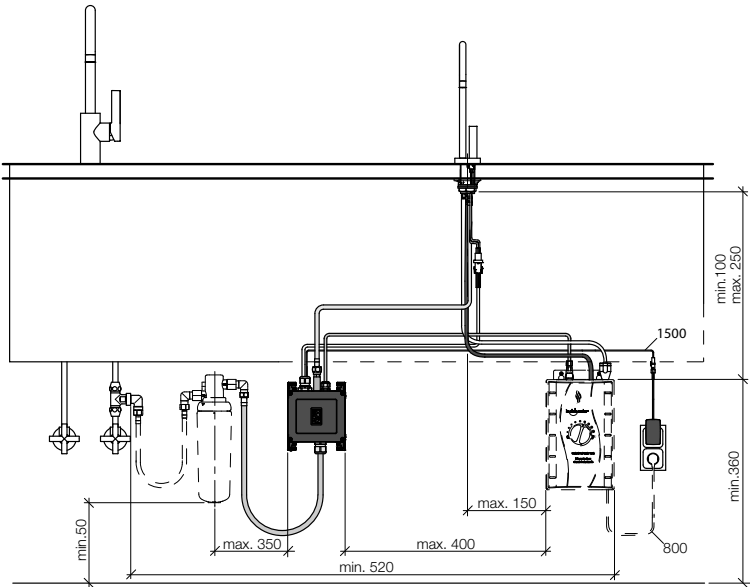

mm

12 892 970 90

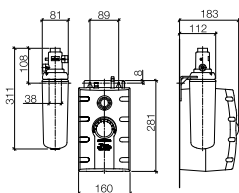

**Hot water tank incl. filter**

- **BS 1363 connector**
- Thermostat regulator (88°C - 98°C)
- Capacity 2.5 litres
- Power 1300 W
- Voltage 220 - 240 volt
- Activated carbon filter (5.0 micron level)
- Chemical and mechanical filtering
- Reduces water hardness (ion exchanger)
- Filters dirt, rust, chlorine and lead particles
- Filter capacity approx. 450 litres

**for use with the TARA ULTRA and LOT series fittings, HOT & COLD WATER DISPENSER 17 861 875 and 17 861 680**

If there is a noticeable reduction of the water supply, or a noticeable decline in water quality, the filter cartridge needs to be replaced. With proper and regular use, we recommend replacing the filter cartridge every six months.

The products are not available in all markets, please contact your Dornbracht sales force.

Note different discount groups, as appropriate.

	Euro
12 892 970 90	782,00

12 896 970 90



**Replacement filter cartridge**

- Activated carbon filter (5.0 micron level)
- Chemical and mechanical filtering
- Reduces water hardness (ion exchanger)
- Filters dirt, rust, chlorine and lead particles
- Filter capacity approx. 450 litres
- **for 12 892 970 90**

The filter cartridge must be changed every six months. The installation instructions contain further information for guidance.

The products are not available in all markets, please contact your Dornbracht sales force.

NOTE: This item is conditioned separately.

	Euro
12 896 970 90	89,40

12 895 970 90



**Replacement filter cartridge**

- Activated carbon filter (5.0 micron level)
- Chemical and mechanical filtering
- Reduces water hardness (ion exchanger)
- Filters dirt, rust, chlorine and lead particles
- Filter capacity approx. 450 litres
- **for 12 890 970 90**

The filter cartridge must be changed every six months. The installation instructions contain further information for guidance.

The products are not available in all markets, please contact your Dornbracht sales force.

NOTE: This item is conditioned separately.

	Euro
12 895 970 90	89,50

# Sync

Sieger Design



## Modifications 2015

The new SYNC series includes two pull-down single-lever mixers with spray function, **33 875 895-FF** and **33 870 895-FF**. The new, dynamic, front-facing design language literally comes towards the user, making work easy and ergonomic. Distinctive for SYNC is the conical transition between the body and the spout, and parallel to it, the inner contour of a lever that has no bevelled edges (available second quarter of 2015).

All Professional Information can also be found at [www.dornbracht.com](http://www.dornbracht.com).

33 875 895

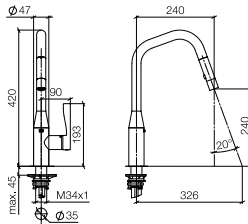

**Single-lever mixer Pull-down with spray function**

- 240 mm projection
- pivotable spout 360°
- optional limiting, pivoting 150°
- hole diameter 35 mm
- Laminar and spray flow
- cartridge with ceramic discs
- 2x pressure hose M 8 x 1 x 600 mm
- 1500 mm metal shower hose
- sprayface with anti-scaling system
- Max. flow 10 l/min at 3 bar flow pressure
- lead-free

Intrinsic protection against back flow.

Available for delivery from the second quarter of 2015

		Euro
polished chrome	33 875 895-00	648,90
platinum matt	33 875 895-06	843,60

33 870 895

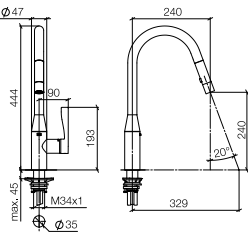

**Single-lever mixer Pull-down with spray function**

- 240 mm projection
- pivotable spout 360°
- optional limiting, pivoting 150°
- hole diameter 35 mm
- Laminar and spray flow
- cartridge with ceramic discs
- 2x pressure hose M 8 x 1 x 600 mm
- 1500 mm metal shower hose
- sprayface with anti-scaling system
- Max. flow 10 l/min at 3 bar flow pressure
- lead-free

Intrinsic protection against back flow.

Available for delivery from the second quarter of 2015

		Euro
polished chrome	33 870 895-00	648,90
platinum matt	33 870 895-06	843,60

eno  
Sieger Design



#### Modifications 2015

The pull-out single-lever mixer **33 845 760-FF** and the pull-out single-lever mixer with spray function **33 875 760-FF** are added to the ENO series.

All Professional Information can also be found at [www.dornbracht.com](http://www.dornbracht.com).

33 875 760



**Single-lever mixer Pull-out with spray function**

- 225 mm projection
- pivotable spout 130°
- hole diameter 35 mm
- cartridge with ceramic discs
- 2x pressure hose M 8 x 1 x 600 mm
- 1600 mm metal shower hose
- Max. flow 8 l/min at 3 bar flow pressure
- lead-free

Available for delivery from the second quarter of 2015

		Euro
polished chrome	33 875 760-00	521,30
platinum matt	33 875 760-06	677,70

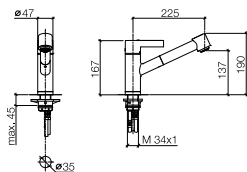

33 845 760



**Single-lever mixer Pull-out**

- 220 mm projection
- pivotable spout 130°
- hole diameter 35 mm
- cartridge with ceramic discs
- 2x pressure hose M 8 x 1 x 600 mm
- 1600 mm metal shower hose
- Max. flow 10 l/min at 3 bar flow pressure
- lead-free

Available for delivery from the second quarter of 2015

		Euro
polished chrome	33 845 760-00	492,30
platinum matt	33 845 760-06	640,00

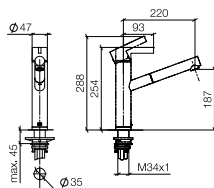

**Recommended miscellaneous**



**Integrated washing-up liquid dispenser without rosette**  
For details see page 099



**Strainer waste with control handle**  
For details see page 096



**Strainer waste, with electronic control**  
For details see page 097

33 870 760



#### Single-lever mixer Pull-out with spray function

- 225 mm projection
- pivotable spout 130°
- hole diameter 35 mm
- cartridge with ceramic discs
- 3x M 10 x 1 x 420 mm high pressure hose
- fabric braided hose 1500 mm
- Max. flow 7 l/min at 3 bar flow pressure
- lead-free

		Euro
polished chrome	33 870 760-00	472,40
platinum matt	33 870 760-06	614,10

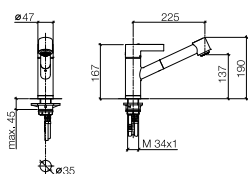

33 840 760



#### Single-lever mixer Pull-out

- 220 mm projection
- pivotable spout 130°
- hole diameter 35 mm
- cartridge with ceramic discs
- 3x M 10 x 1 x 420 mm high pressure hose
- fabric braided hose 1500 mm
- Max. flow 8 l/min at 3 bar flow pressure
- lead-free

		Euro
polished chrome	33 840 760-00	443,30
platinum matt	33 840 760-06	576,50

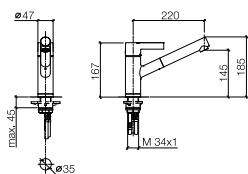

#### Recommended miscellaneous



**Integrated washing-up liquid dispenser without rosette**  
For details see page 099



**Strainer waste with control handle**  
For details see page 096



**Strainer waste, with electronic control**  
For details see page 097

33 800 760



**Single-lever mixer**

- **220 mm projection**
- pivotable spout 130°
- hole diameter 35 mm
- cartridge with ceramic discs
- 2x M 10 x 1 x 420 mm high pressure hose
- Max. flow 8 l/min at 3 bar flow pressure
- lead-free

		Euro
polished chrome	33 800 760-00	390,80
platinum matt	33 800 760-06	508,00

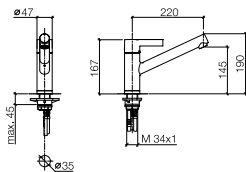

**Recommended miscellaneous**



**Integrated washing-up liquid dispenser without rosette**  
For details see page 099



**Strainer waste with control handle**  
For details see page 096



**Strainer waste, with electronic control**  
For details see page 097

# Elio

Sieger Design



All Professional Information can also be found at [www.dornbracht.com](http://www.dornbracht.com).

33 870 790



**Single-lever mixer Pull-out with spray function**

- 235 mm projection
- pivotable spout 360°
- hole diameter 35 mm
- cartridge with ceramic discs
- 3x M 10 x 1 x 420 mm high pressure hose
- fabric braided hose 1500 mm
- Max. flow 7 l/min at 3 bar flow pressure
- lead-free

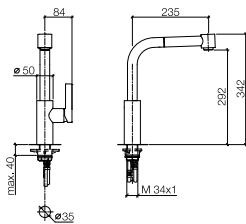

		Euro
polished chrome	33 870 790-00	587,30
platinum matt	33 870 790-06	763,40

33 870 791



**Single-lever mixer Pull-out with spray function, with lever on left**

- 235 mm projection
- pivotable spout 360°
- hole diameter 35 mm
- cartridge with ceramic discs
- 3x M 10 x 1 x 420 mm high pressure hose
- fabric braided hose 1500 mm
- Max. flow 7 l/min at 3 bar flow pressure
- lead-free

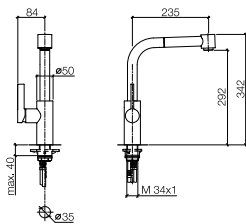

		Euro
polished chrome	33 870 791-00	685,00
platinum matt	33 870 791-06	890,40

**Recommended miscellaneous**



**Integrated washing-up liquid dispenser without rosette**  
For details see page 099



**Strainer waste with control handle**  
For details see page 096



**Strainer waste, with electronic control**  
For details see page 097

33 890 790



### Single-lever mixer Pull-out with spray function, for open hot-water boilers (low pressure)

- 235 mm projection
- pivotable spout 360°
- hole diameter 35 mm
- cartridge with ceramic discs
- 2x M 10 x 3/8" x 500 mm high pressure hose
- 1x M 10 x 1 x 420 mm high pressure hose
- fabric braided hose 1500 mm
- Max. flow 7 l/min at 3 bar flow pressure
- lead-free

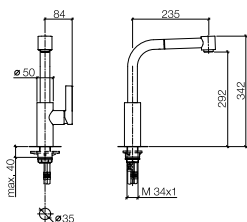

		Euro
polished chrome	33 890 790-00	685,00
platinum matt	33 890 790-06	890,40

33 840 790



### Single-lever mixer Pull-out

- 235 mm projection
- pivotable spout 360°
- hole diameter 35 mm
- cartridge with ceramic discs
- 3x M 10 x 1 mm x 420 mm high pressure hose
- fabric braided hose 1500 mm
- Max. flow 8 l/min at 3 bar flow pressure
- lead-free

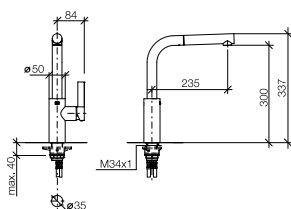

		Euro
polished chrome	33 840 790-00	558,30
platinum matt	33 840 790-06	725,70

## Recommended miscellaneous



**Integrated washing-up liquid dispenser without rosette**  
For details see page 099



**Strainer waste with control handle**  
For details see page 096



**Strainer waste, with electronic control**  
For details see page 097

33 800 790

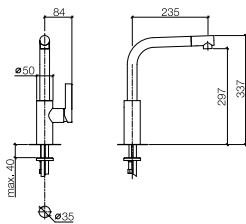

Single-lever mixer

- 235 mm projection
- spout, end-piece with 20° rotation
- pivotable spout 360°
- hole diameter 35 mm
- cartridge with ceramic discs
- 2x M 10 x 1 x 420 mm high pressure hose
- Max. flow 8 l/min at 3 bar flow pressure
- lead-free

		Euro
polished chrome	33 800 790-00	528,20
platinum matt	33 800 790-06	686,70

33 826 790 +  
27 719 970

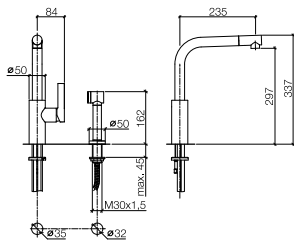

Single-lever mixer with rinsing spray set

- 235 mm projection
- pivotable spout 360°
- spout, end-piece with 20° rotation
- hole diameter rinsing spray 32 mm
- Single-lever mixer hole diameter 35 mm
- cartridge with ceramic discs
- 2x M 10 x 1 x 420 mm high pressure hose
- 1x M 10 x 1/2" x 420 mm high pressure hose
- fabric braided hose 1500 mm
- Max. flow 8 l/min at 3 bar flow pressure
- sprayface with anti-scaling system
- lead-free

Intrinsic protection against back flow.

Recommended minimum flow pressure: 2.5 bar.

		Euro
polished chrome	1x 33 826 790-00	528,20
	1x 27 719 970-00	365,20
	<b>Total price:</b>	<b>893,40</b>
platinum matt	1x 33 826 790-06	686,70
	1x 27 719 970-06	547,90
	<b>Total price:</b>	<b>1.234,60</b>

Recommended miscellaneous



Integrated washing-up liquid  
dispenser without rosette  
For details see page 099



Strainer waste with control  
handle  
For details see page 096



Strainer waste, with electronic  
control  
For details see page 097

33 826 790 +  
27 789 970

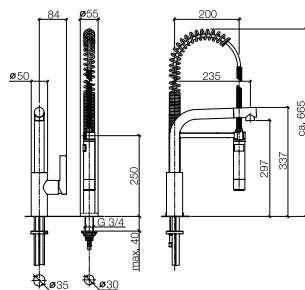

#### Single-lever mixer with profi spray set

- 235 mm projection
- pivotable spout 360°
- spout, end-piece with 20° rotation
- Single-lever mixer hole diameter 35 mm
- Profi spray hole diameter 30 mm
- cartridge with ceramic discs
- 2x M 10 x 1 x 420 mm high pressure hose
- 1x M 10 x 1/2" x 420 mm high pressure hose
- Max. flow 8 l/min at 3 bar flow pressure
- sprayface with anti-scaling system
- lead-free

Intrinsic protection against back flow.

Recommended minimum flow pressure: 2.5 bar.

		Euro
polished chrome	1x 33 826 790-00	528,20
	1x 27 789 970-00	891,60
	<b>Total price:</b>	<b>1.419,80</b>
platinum matt	1x 33 826 790-06	686,70
	1x 27 789 970-06	1.337,20
	<b>Total price:</b>	<b>2.023,90</b>

32 800 790

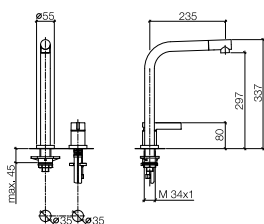

#### Two-hole mixer with individual rosettes

- 235 mm projection
- spout, end-piece with 20° rotation
- pivotable spout 360°
- hole diameter spout 35 mm
- Mixer hole diameter 35 mm
- cartridge with ceramic discs
- 1x M 10 x 1/2" x 420 mm high pressure hose
- 2x M 10 x 1 x 420 mm high pressure hose
- lead-free

Operating unit can be positioned freely.

		Euro
polished chrome	32 800 790-00	614,10
platinum matt	32 800 790-06	798,30

#### Recommended miscellaneous



**Integrated washing-up liquid dispenser with rosette**  
For details see page 099



**Strainer waste with control handle**  
For details see page 096



**Strainer waste, with electronic control**  
For details see page 097

32 800 790 +  
27 719 970

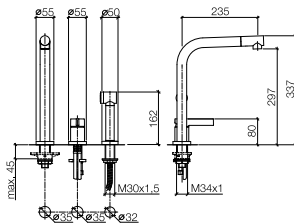

**Two-hole mixer with individual rosettes and rinsing spray set**

- 235 mm projection
- spout, end-piece with 20° rotation
- pivotable spout 360°
- hole diameter rinsing spray 32 mm
- hole diameter spout 35 mm
- Mixer hole diameter 35 mm
- cartridge with ceramic discs
- 1x M 10 x 1/2" x 420 mm high pressure hose
- 2x M 10 x 1 x 420 mm high pressure hose
- fabric braided hose 1500 mm
- sprayface with anti-scaling system
- Max. flow 8 l/min at 3 bar flow pressure
- lead-free

Intrinsic protection against back flow.

Recommended minimum flow pressure: 2.5 bar.

Operating unit can be positioned freely.

		Euro
polished chrome	1x 32 800 790-00	614,10
	1x 27 719 970-00	365,20
	<b>Total price:</b>	<b>979,30</b>
platinum matt	1x 32 800 790-06	798,30
	1x 27 719 970-06	547,90
	<b>Total price:</b>	<b>1.346,20</b>

32 800 790 +  
27 789 970

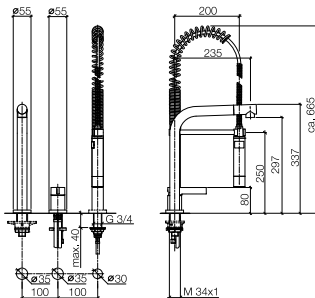

**Two-hole mixer with individual rosettes and Profi spray set**

- 235 mm projection
- spout, end-piece with 20° rotation
- pivotable spout 360°
- Profi spray hole diameter 30 mm
- hole diameter spout 35 mm
- Mixer hole diameter 35 mm
- 1x M 10 x 1/2" x 500 mm high pressure hose
- cartridge with ceramic discs
- 1x M 10 x 1/2" x 420 mm high pressure hose
- 2x M 10 x 1 x 420 mm high pressure hose
- Max. flow 8 l/min at 3 bar flow pressure
- sprayface with anti-scaling system
- lead-free

Intrinsic protection against back flow.

Recommended minimum flow pressure: 2.5 bar.

Operating unit can be positioned freely.

		Euro
polished chrome	1x 32 800 790-00	614,10
	1x 27 789 970-00	891,60
	<b>Total price:</b>	<b>1.505,70</b>
platinum matt	1x 32 800 790-06	798,30
	1x 27 789 970-06	1.337,20
	<b>Total price:</b>	<b>2.135,50</b>

**Recommended miscellaneous**



**Integrated washing-up liquid dispenser with rosette**  
For details see page 099



**Strainer waste with control handle**  
For details see page 096



**Strainer waste, with electronic control**  
For details see page 097

# Tara Ultra

Sieger Design



## Modifications 2015

The pull-down single-lever mixer with spray function **33 870 875-FF** is added to the TARA ULTRA series.

All Professional Information can also be found at [www.dornbracht.com](http://www.dornbracht.com).

33 800 875

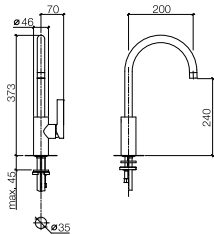

**Single-lever mixer**

- 200 mm projection
- pivotable spout 360°
- hole diameter 35 mm
- cartridge with ceramic discs
- 2x M 10 x 1 x 420 mm high pressure hose
- Max. flow 8 l/min at 3 bar flow pressure
- lead-free

		Euro
polished chrome	33 800 875-00	476,50
platinum matt	33 800 875-06	714,70

33 816 875

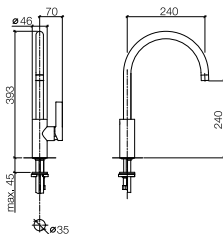

**Single-lever mixer**

- 240 mm projection
- pivotable spout 360°
- hole diameter 35 mm
- cartridge with ceramic discs
- 2x M 10 x 1 x 420 mm high pressure hose
- Max. flow 8 l/min at 3 bar flow pressure
- lead-free

		Euro
polished chrome	33 816 875-00	489,00
platinum matt	33 816 875-06	733,70

**Recommended miscellaneous**



**Integrated washing-up liquid dispenser without rosette**  
For details see page 099



**Strainer waste with control handle**  
For details see page 096



**Strainer waste, with electronic control**  
For details see page 097

33 816 876

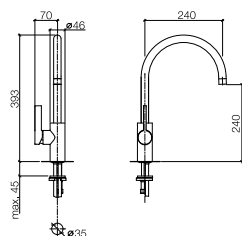

#### Single-lever mixer with lever on left

- 240 mm projection
- pivotable spout 360°
- hole diameter 35 mm
- cartridge with ceramic discs
- 2x M 10 x 1 x 420 mm high pressure hose
- Max. flow 8 l/min at 3 bar flow pressure
- lead-free

		Euro
polished chrome	33 816 876-00	501,80
platinum matt	33 816 876-06	752,80

33 850 875

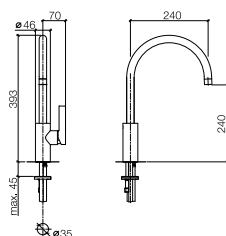

#### Single-lever mixer for open hot-water boilers (low pressure)

- 240 mm projection
- pivotable spout 360°
- hole diameter 35 mm
- cartridge with ceramic discs
- 2x M 10 x 3/8" x 500 mm high pressure hose
- 1x M 10 x 3/8" x 420 mm high pressure hose
- Max. flow 8 l/min at 3 bar flow pressure
- lead-free



		Euro
polished chrome	33 850 875-00	547,90
platinum matt	33 850 875-06	821,60

### Recommended miscellaneous



**Integrated washing-up liquid dispenser without rosette**  
For details see page 099



**Strainer waste with control handle**  
For details see page 096



**Strainer waste, with electronic control**  
For details see page 097

33 818 875

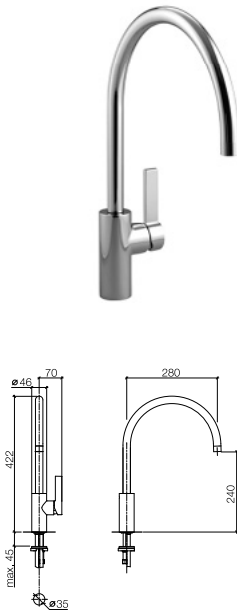

**Single-lever mixer**

- 280 mm projection
- pivotable spout 360°
- hole diameter 35 mm
- cartridge with ceramic discs
- 2x M 10 x 1 x 420 mm high pressure hose
- Max. flow 8 l/min at 3 bar flow pressure
- lead-free

		Euro
polished chrome	33 818 875-00	501,80
platinum matt	33 818 875-06	752,80

33 826 875 +  
27 719 970

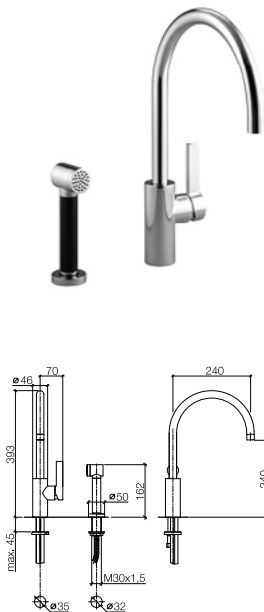

**Single-lever mixer with rinsing spray set**

- 240 mm projection
- pivotable spout 360°
- hole diameter rinsing spray 32 mm
- Single-lever mixer hole diameter 35 mm
- cartridge with ceramic discs
- 2x M 10 x 1 x 420 mm high pressure hose
- 1x M 10 x 1/2" x 420 mm high pressure hose
- fabric braided hose 1500 mm
- Max. flow 8 l/min at 3 bar flow pressure
- sprayface with anti-scaling system
- lead-free

Recommended minimum flow pressure: 2.5 bar.  
Intrinsic protection against back flow.

		Euro
polished chrome	1x 33 826 875-00	501,80
	1x 27 719 970-00	365,20
	<b>Total price:</b>	<b>867,00</b>
platinum matt	1x 33 826 875-06	752,80
	1x 27 719 970-06	547,90
	<b>Total price:</b>	<b>1.300,70</b>

**Recommended miscellaneous**



**Integrated washing-up liquid  
dispenser without rosette**  
For details see page 099



**Strainer waste with control  
handle**  
For details see page 096



**Strainer waste, with electronic  
control**  
For details see page 097

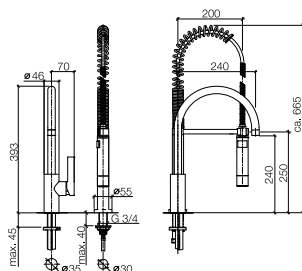

Recommended minimum flow pressure: 2.5 bar.  
Intrinsic protection against back flow.

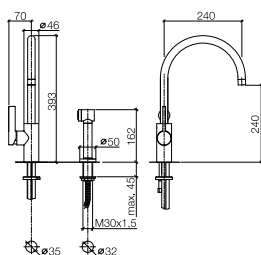

Recommended minimum flow pressure: 2.5 bar.  
Intrinsic protection against back flow.



DORNBRACHT . 039

33 826 876 +  
27 789 970



**Single-lever mixer with lever on left and Profi spray set**

- 240 mm projection
- pivotable spout 360°
- Single-lever mixer hole diameter 35 mm
- Profi spray hole diameter 30 mm
- 1x M 10 x 1/2" x 500 mm high pressure hose
- cartridge with ceramic discs
- 1x M 10 x 1/2" x 420 mm high pressure hose
- Max. flow 8 l/min at 3 bar flow pressure
- sprayface with anti-scaling system
- lead-free

Recommended minimum flow pressure: 2.5 bar.  
Intrinsic protection against back flow.

		Euro
polished chrome	1x 33 826 876-00	514,50
	1x 27 789 970-00	891,60
	<b>Total price:</b>	<b>1.406,10</b>
platinum matt	1x 33 826 876-06	771,80
	1x 27 789 970-06	1.337,20
	<b>Total price:</b>	<b>2.109,00</b>

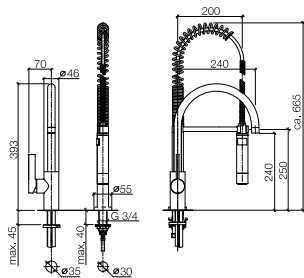

**Recommended miscellaneous**



**Integrated washing-up liquid dispenser without rosette**  
For details see page 099



**Strainer waste with control handle**  
For details see page 096

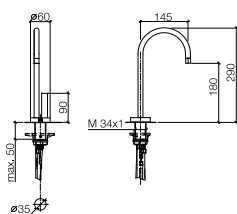

**Strainer waste, with electronic control**  
For details see page 097

**HOT & COLD WATER DISPENSER**

- **145 mm projection**
- rigid, thermally insulated spout
- hole diameter 35 mm
- Provides filtered, hot water up to 93°C
- Provides filtered, cold water
- Max. flow 2 l/min at 3 bar flow pressure
- ready-to-use control unit for wall mounting (135 mm x 160 mm x 60 mm)
- electronic magnetic valve
- 100-230 V, 50-60 Hz, 18 W power supply unit, incl. country-specific adapter set
- lead-free

A minimum flow pressure of 3 bar is necessary for the HOT & COLD WATER DISPENSER to work perfectly in conjunction with a hot water tank and filter.

The filter cartridge must be changed every six months. The installation instructions contain further information for guidance.

All Professional Information and detailed planning information can be found at [www.dornbracht.com](http://www.dornbracht.com)

		Euro
polished chrome	17 861 875-00	614,70
platinum matt	17 861 875-06	922,00

**Required miscellaneous****Hot water tank incl. filter**

12 892 970 90

**Euro****782,00**

For details see page 022

**Optional miscellaneous****Single sink 210 mm x 405 mm**

matt high-grade steel

38 001 000-86

**Euro****1.346,10**

Installation, on top or flush

For details see page 089

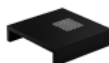
**Optional miscellaneous****DRINKING PLATE**

black

84 710 000-13

**Euro****148,50**

for placing in the single sink

For details see page 102

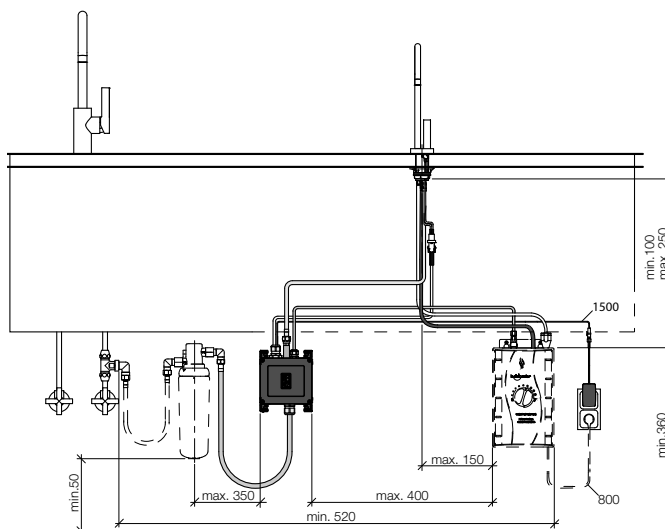

mm

**Recommended miscellaneous****Integrated washing-up liquid dispenser without rosette**

For details see page 099

**Strainer waste with control handle**

For details see page 096

**Strainer waste, with electronic control**

For details see page 097

33 805 875

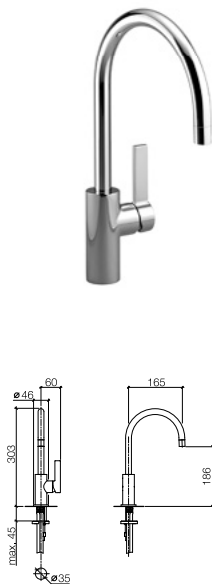

**BAR TAP, single-lever mixer**

- 165 mm projection
- pivotable spout 360°
- hole diameter 35 mm
- cartridge with ceramic discs
- 2x M 10 x 1 x 420 mm high pressure hose
- Max. flow 8 l/min at 3 bar flow pressure
- lead-free
- laminar flow

		Euro
polished chrome	33 805 875-00	463,80
platinum matt	33 805 875-06	695,60

33 870 875



**Single-lever mixer Pull-down with spray function**

- 240 mm projection
- pivotable spout 360°
- optional limiting, pivoting 150°
- hole diameter 35 mm
- Laminar and spray flow
- cartridge with ceramic discs
- 2x pressure hose M 8 x 1 x 600 mm
- 1500 mm metal shower hose
- sprayface with anti-scaling system
- Max. flow 10 l/min at 3 bar flow pressure
- lead-free

Intrinsic protection against back flow.

Available for delivery from the second quarter of 2015

		Euro
polished chrome	33 870 875-00	587,30
platinum matt	33 870 875-06	763,30

**Recommended miscellaneous**



**Integrated washing-up liquid dispenser without rosette**  
For details see page 099



**Strainer waste with control handle**  
For details see page 096



**Strainer waste, with electronic control**  
For details see page 097

33 860 875

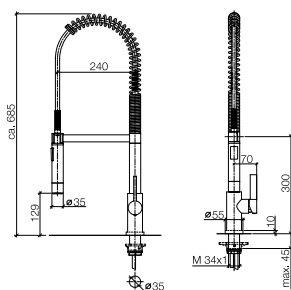
**Profi single-lever mixer**

- 240 mm projection
- pivotable 360°
- hole diameter 35 mm
- Normal and spray flow
- cartridge with ceramic discs
- 2x M 10 x 1 x 420 mm high pressure hose
- anti-scale system
- Max. flow 8 l/min at 3 bar flow pressure
- lead-free

Intrinsic protection against back flow.

		Euro
polished chrome	33 860 875-00	1.015,30
platinum matt	33 860 875-06	1.523,00

32 835 875

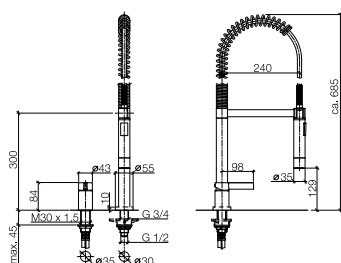
**Profi two-hole mixer**

- 240 mm projection
- pivotable 360°
- Profi spray hole diameter 30 mm
- Normal and spray flow
- cartridge with ceramic discs
- 2x M 10 x 1 x 420 mm high pressure hose
- 1x M 10 x 1/2" x 420 mm high pressure hose
- anti-scale system
- Max. flow 8 l/min at 3 bar flow pressure
- lead-free
- Hole diameter of profi spray 30 mm

Intrinsic protection against back flow.

		Euro
polished chrome	32 835 875-00	1.064,10
platinum matt	32 835 875-06	1.596,30

**Recommended miscellaneous**

**Integrated washing-up liquid dispenser without rosette**

For details see page 099



**Strainer waste with control handle**

For details see page 096



**Strainer waste, with electronic control**

For details see page 097

33 845 875



**PIVOT, single-lever mixer**

- 552 mm projection
- pivotable spout 360°
- hole diameter 35 mm
- cartridge with ceramic discs
- 2x pressure hose M 8 x 1 x 600 mm
- Max. flow 8 l/min at 3 bar flow pressure
- lead-free

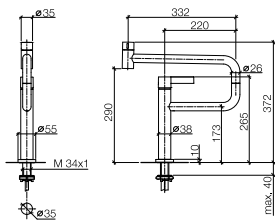

		Euro
polished chrome	33 845 875-00	923,30
platinum matt	33 845 875-06	1.384,90
cyprum	33 845 875-49	1.846,60

17 800 875



**POT FILLER, cold-water valve**

- 500 mm projection
- pivotable spout 360°
- hole diameter 35 mm
- cold water only
- Max. flow 8 l/min at 3 bar flow pressure
- lead-free
- laminar flow

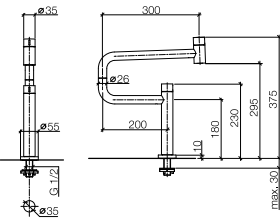

		Euro
polished chrome	17 800 875-00	732,00
platinum matt	17 800 875-06	1.098,20

**Recommended miscellaneous**



**Integrated washing-up liquid dispenser without rosette**  
For details see page 099



**Strainer waste with control handle**  
For details see page 096



**Strainer waste, with electronic control**  
For details see page 097

37 847 875

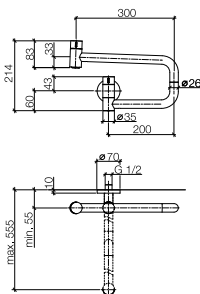

- **500 mm projection**
- pivoting spout
- cold water only
- Laminar flow
- Max. flow 11 l/min at 3 bar flow pressure
- lead-free

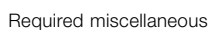

- Min. recess depth 70 mm

For details see page 104

Concealed rough parts	35 086 970 90	82,80
-----------------------	---------------	-------

- **240 mm projection**
- pivotable spout 360°
- Single-lever mixer hole diameter 35 mm
- hole diameter strainer waste 25 mm
- hole diameter rinsing spray 32 mm
- Washing-up liquid dispenser hole diameter 30 mm
- fabric braided hose 1500 mm
- sprayface with anti-scaling system
- Max. flow 8 l/min at 3 bar flow pressure
- lead-free

Intrinsic protection against back flow.

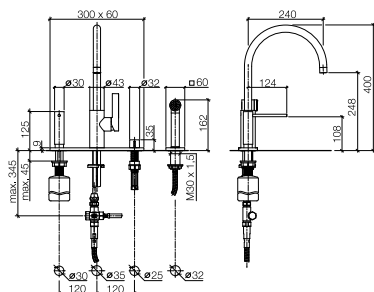

		Euro
polished chrome	37 847 875-00	1.251,70
platinum matt	37 847 875-06	1.877,60



# Lot

Sieger Design



32 800 680

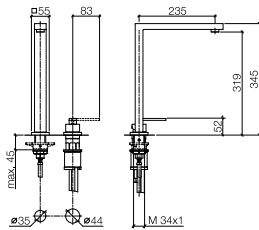

Two-hole mixer with individual rosettes

- 235 mm projection
- pivotable spout 360°
- Mixer hole diameter 44 mm
- hole diameter spout 35 mm
- cartridge with ceramic discs
- 1x M 10 x 1/2" x 420 mm high pressure hose
- 2x M 10 x 1 x 420 mm high pressure hose
- Max. flow 8 l/min at 3 bar flow pressure
- lead-free

Operating unit can be positioned freely.

		Euro
polished chrome	32 800 680-00	1.190,40
platinum matt	32 800 680-06	1.785,60

32 800 680 +  
27 714 970

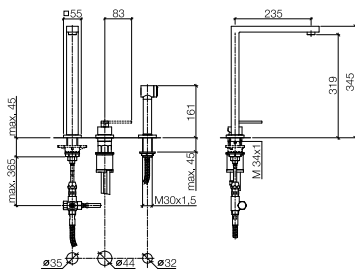

Two-hole mixer with individual rosettes and  
rinsing spray set

- 235 mm projection
- pivotable spout 360°
- hole diameter rinsing spray 32 mm
- Mixer hole diameter 44 mm
- hole diameter spout 35 mm
- cartridge with ceramic discs
- 1x M 10 x 1/2" x 420 mm high pressure hose
- 2x M 10 x 1 x 420 mm high pressure hose
- fabric braided hose 1500 mm
- Max. flow 8 l/min at 3 bar flow pressure
- sprayface with anti-scaling system
- lead-free

Intrinsic protection against back flow.

Recommended minimum flow pressure: 2.5 bar.

Operating unit can be positioned freely.

		Euro
polished chrome	1x 32 800 680-00	1.190,40
	1x 27 714 970-00	396,10
	<b>Total price:</b>	<b>1.586,50</b>
platinum matt	1x 32 800 680-06	1.785,60
	1x 27 714 970-06	594,20
	<b>Total price:</b>	<b>2.379,80</b>

Recommended miscellaneous



Integrated washing-up liquid  
dispenser with rosette  
For details see page 098



Strainer waste with twist knob  
For details see page 096



Strainer waste, with electronic  
control  
For details see page 097

32 800 680 +  
27 784 970

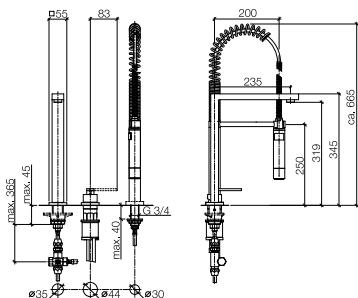

## Two-hole mixer with individual rosettes and Profi spray set

- 235 mm projection
- pivotable spout 360°
- Profi spray hole diameter 30 mm
- Mixer hole diameter 44 mm
- hole diameter spout 35 mm
- cartridge with ceramic discs
- 1x M 10 x 1/2" x 420 mm high pressure hose
- 2x M 10 x 1 x 420 mm high pressure hose
- 1x M 10 x 1/2" x 500 mm high pressure hose
- Max. flow 8 l/min at 3 bar flow pressure
- sprayface with anti-scaling system
- lead-free

Intrinsic protection against back flow.

Recommended minimum flow pressure: 2.5 bar.

Operating unit can be positioned freely.

		Euro
polished chrome	1x 32 800 680-00	1.190,40
	1x 27 784 970-00	944,50
	<b>Total price:</b>	<b>2.134,90</b>
platinum matt	1x 32 800 680-06	1.785,60
	1x 27 784 970-06	1.417,10
	<b>Total price:</b>	<b>3.202,70</b>

32 812 680

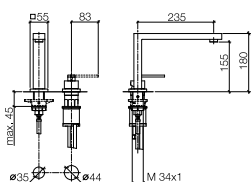

## Two-hole mixer with individual rosettes

- 235 mm projection
- pivotable spout 360°
- Mixer hole diameter 44 mm
- hole diameter spout 35 mm
- cartridge with ceramic discs
- 1x M 10 x 1/2" x 420 mm high pressure hose
- 2x M 10 x 1 x 420 mm high pressure hose
- Max. flow 8 l/min at 3 bar flow pressure
- lead-free

Operating unit can be positioned freely.

		Euro
polished chrome	32 812 680-00	1.100,50
platinum matt	32 812 680-06	1.650,70

## Recommended miscellaneous



**Integrated washing-up liquid dispenser with rosette**  
For details see page 098



**Strainer waste with twist knob**  
For details see page 096



**Strainer waste, with electronic control**  
For details see page 097

32 812 680 +  
27 714 970



## Two-hole mixer with individual rosettes and rinsing spray set

- 235 mm projection
- pivotable spout 360°
- hole diameter rinsing spray 32 mm
- Mixer hole diameter 44 mm
- hole diameter spout 35 mm
- cartridge with ceramic discs
- 1x M 10 x 1/2" x 420 mm high pressure hose
- 2x M 10 x 1 x 420 mm high pressure hose
- fabric braided hose 1500 mm
- Max. flow 8 l/min at 3 bar flow pressure
- sprayface with anti-scaling system
- lead-free

Intrinsic protection against back flow.

Recommended minimum flow pressure: 2.5 bar.

Operating unit can be positioned freely.

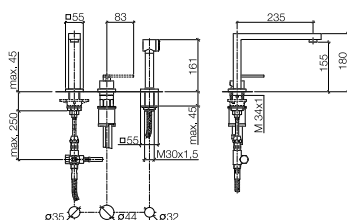

		Euro
polished chrome	1x 32 812 680-00	1.100,50
	1x 27 714 970-00	396,10
	<b>Total price:</b>	<b>1.496,60</b>
platinum matt	1x 32 812 680-06	1.650,70
	1x 27 714 970-06	594,20
	<b>Total price:</b>	<b>2.244,90</b>

32 812 680 +  
27 784 970



## Two-hole mixer with individual rosettes and Profi spray set

- 235 mm projection
- pivotable spout 360°
- Profi spray hole diameter 30 mm
- Mixer hole diameter 44 mm
- hole diameter spout 35 mm
- cartridge with ceramic discs
- 1x M 10 x 1/2" x 420 mm high pressure hose
- 2x M 10 x 1 x 420 mm high pressure hose
- 1x M 10 x 1/2" x 500 mm high pressure hose
- Max. flow 8 l/min at 3 bar flow pressure
- sprayface with anti-scaling system
- lead-free

Intrinsic protection against back flow.

Recommended minimum flow pressure: 2.5 bar.

Operating unit can be positioned freely.

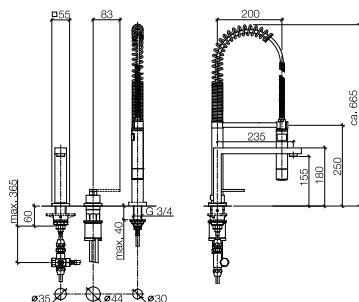

		Euro
polished chrome	1x 32 812 680-00	1.100,50
	1x 27 784 970-00	944,50
	<b>Total price:</b>	<b>2.045,00</b>
platinum matt	1x 32 812 680-06	1.650,70
	1x 27 784 970-06	1.417,10
	<b>Total price:</b>	<b>3.067,80</b>

## Recommended miscellaneous



**Integrated washing-up liquid dispenser with rosette**

For details see page 098



**Strainer waste with twist knob**

For details see page 096



**Strainer waste, with electronic control**

For details see page 097

32 843 680

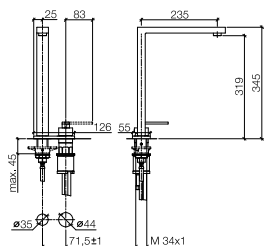
**Two-hole mixer with cover plate**

- 235 mm projection
- pivotable spout 360°
- Mixer hole diameter 44 mm
- hole diameter spout 35 mm
- cartridge with ceramic discs
- 1x M 10 x 1/2" x 420 mm high pressure hose
- 2x M 10 x 1 x 420 mm high pressure hose
- Max. flow 8 l/min at 3 bar flow pressure
- lead-free

		Euro
polished chrome	32 843 680-00	1.190,40
platinum matt	32 843 680-06	1.785,60

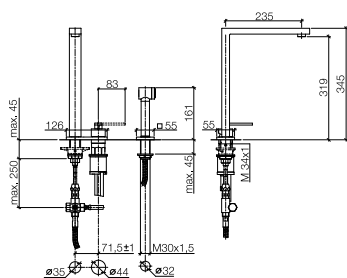
32 843 680 +  
27 714 970**Two-hole mixer with cover plate and rinsing spray set**

- 235 mm projection
- pivotable spout 360°
- hole diameter rinsing spray 32 mm
- Mixer hole diameter 44 mm
- hole diameter spout 35 mm
- cartridge with ceramic discs
- 1x M 10 x 1/2" x 420 mm high pressure hose
- 2x M 10 x 1 x 420 mm high pressure hose
- fabric braided hose 1500 mm
- Max. flow 8 l/min at 3 bar flow pressure
- sprayface with anti-scaling system
- lead-free

Intrinsic protection against back flow.

Recommended minimum flow pressure: 2.5 bar.

		Euro
polished chrome	1x 32 843 680-00	1.190,40
	1x 27 714 970-00	396,10
	<b>Total price:</b>	<b>1.586,50</b>
platinum matt	1x 32 843 680-06	1.785,60
	1x 27 714 970-06	594,20
	<b>Total price:</b>	<b>2.379,80</b>

**Recommended miscellaneous**

**Integrated washing-up liquid dispenser with rosette**  
For details see page 098



**Strainer waste with twist knob**  
For details see page 096



**Strainer waste, with electronic control**  
For details see page 097

32 843 680 +  
27 784 970

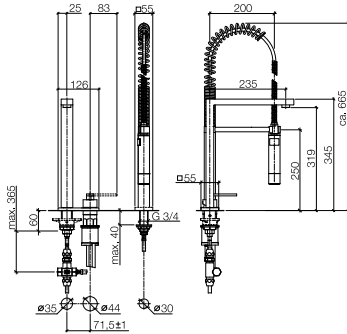

**Two-hole mixer with cover plate and Profi spray set**

- 235 mm projection
- pivotable spout 360°
- Profi spray hole diameter 30 mm
- Mixer hole diameter 44 mm
- hole diameter spout 35 mm
- cartridge with ceramic discs
- 1x M 10 x 1/2" x 420 mm high pressure hose
- 2x M 10 x 1 x 420 mm high pressure hose
- 1x M 10 x 1/2" x 500 mm high pressure hose
- Max. flow 8 l/min at 3 bar flow pressure
- sprayface with anti-scaling system
- lead-free

Intrinsic protection against back flow.

Recommended minimum flow pressure: 2.5 bar.

		Euro
polished chrome	1x 32 843 680-00	1.190,40
	1x 27 784 970-00	944,50
	<b>Total price:</b>	<b>2.134,90</b>
platinum matt	1x 32 843 680-06	1.785,60
	1x 27 784 970-06	1.417,10
	<b>Total price:</b>	<b>3.202,70</b>

32 835 680

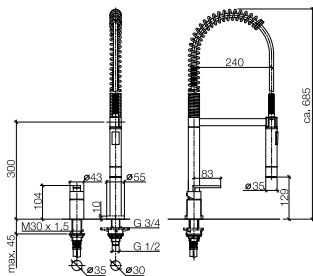

**Profi two-hole mixer**

- 240 mm projection
- pivotable 360°
- Profi spray hole diameter 30 mm
- Mixer hole diameter 35 mm
- Normal and spray flow
- cartridge with ceramic discs
- anti-scale system
- Max. flow 8 l/min at 3 bar flow pressure
- lead-free

Intrinsic protection against back flow.

		Euro
polished chrome	32 835 680-00	1.130,90
platinum matt	32 835 680-06	1.696,50

**Recommended miscellaneous**



**Integrated washing-up liquid dispenser with rosette**  
For details see page 098



**Strainer waste with twist knob**  
For details see page 096



**Strainer waste, with electronic control**  
For details see page 097

32 805 680

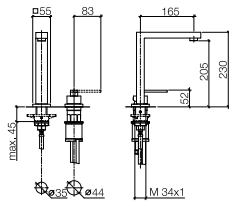

**BAR TAP, two-hole mixer with individual rosettes**

- 165 mm projection
  - pivotable spout 360°
  - Mixer hole diameter 44 mm
  - hole diameter spout 35 mm
  - cartridge with ceramic discs
  - 1x M 10 x 1/2" x 420 mm high pressure hose
  - 2x M 10 x 1 x 420 mm high pressure hose
  - Max. flow 8 l/min at 3 bar flow pressure
  - lead-free
- Operating unit can be positioned freely.

		Euro
polished chrome	32 805 680-00	931,20
platinum matt	32 805 680-06	1.397,20

**Recommended miscellaneous**



**Integrated washing-up liquid dispenser with rosette**  
For details see page 098



**Strainer waste with twist knob**  
For details see page 096



**Strainer waste, with electronic control**  
For details see page 097

17 861 680

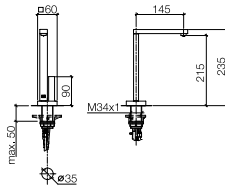

**HOT & COLD WATER DISPENSER**

- **145 mm projection**
- rigid, thermally insulated spout
- hole diameter 35 mm
- Provides filtered, hot water up to 93°C
- Provides filtered, cold water
- Max. flow 2 l/min at 3 bar flow pressure
- ready-to-use control unit for wall mounting (135 mm x 160 mm x 60 mm)
- electronic magnetic valve
- 100-230 V, 50-60 Hz, 18 W power supply unit, incl. country-specific adapter set
- lead-free

A minimum flow pressure of 3 bar is necessary for the HOT & COLD WATER DISPENSER to work perfectly in conjunction with a hot water tank and filter.

The filter cartridge must be changed every six months. The installation instructions contain further information for guidance.

All Professional Information and detailed planning information can be found at [www.dornbracht.com](http://www.dornbracht.com)

		Euro
polished chrome	17 861 680-00	999,20
platinum matt	17 861 680-06	1.498,90

Required miscellaneous		Euro
 <b>Hot water tank incl. filter</b>	12 892 970 90	782,00
For details see page 022		

Optional miscellaneous		Euro
 <b>Single sink 210 mm x 405 mm</b>	matt high-grade steel	38 001 000-86 1.346,10
Installation, on top or flush		
For details see page 089		

Optional miscellaneous		Euro
 <b>DRINKING PLATE</b>	black	84 710 000-13 148,50
for placing in the single sink		
For details see page 102		

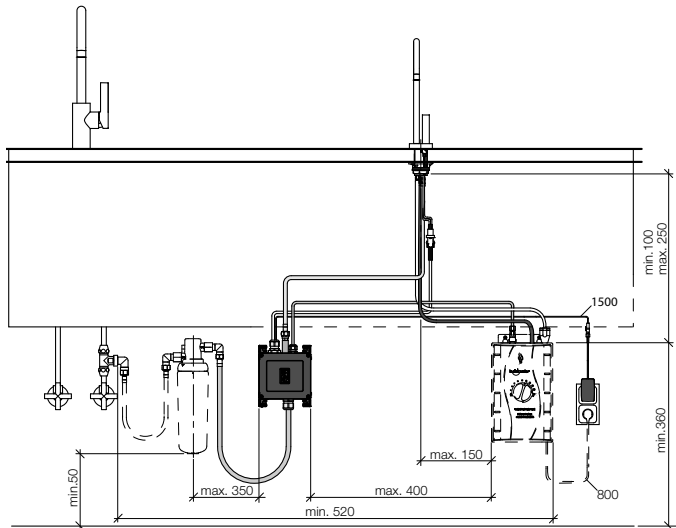

mm

**Recommended miscellaneous**



**Integrated washing-up liquid dispenser with rosette**  
For details see page 098



**Strainer waste with twist knob**  
For details see page 096



**Strainer waste, with electronic control**  
For details see page 097

37 849 680



**PREP SET, Profi two-hole mixer**

- **240 mm projection**
  - pivotable 360°
  - Profi spray hole diameter 30 mm
  - Mixer hole diameter 35 mm
  - hole diameter strainer waste 25 mm
  - cartridge with ceramic discs
  - anti-scale system
  - laminar flow and spray flow max. 8 l/min at 3 bar flow pressure
  - lead-free
  - laminar flow and spray flow
- Intrinsic protection against back flow.

		Euro
polished chrome	37 849 680-00	1.386,00
platinum matt	37 849 680-06	2.079,10

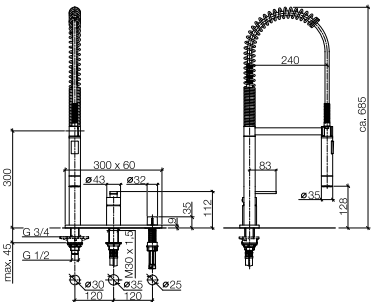

**Recommended miscellaneous**



**Integrated washing-up liquid dispenser with rosette**  
For details see page 098



**Strainer waste with twist knob**  
For details see page 096



**Strainer waste, with electronic control**  
For details see page 097

36 820 680

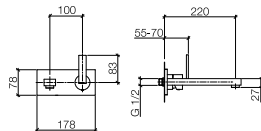

Wall-mounted mixer with cover plate

Exposed trim parts

- 220 mm projection
- fixed spout
- Max. flow 5.5 l/min at 3 bar flow pressure
- lead-free

Mixer can be placed above, to the right or to the left of the spout.

		Euro
polished chrome	36 820 680-00	796,80
platinum matt	36 820 680-06	1.195,40



Required miscellaneous

Concealed body, mixer on right

For details see page 104

Concealed rough parts

35 806 970 90 225,40



Required miscellaneous

Concealed body, mixer on left

For details see page 104

Concealed rough parts

35 807 970 90 225,40



Required miscellaneous

Concealed body, mixer at top

For details see page 105

Concealed rough parts

35 808 970 90 225,40



Required miscellaneous

Wall-mounted mixer, mixer on right

for back panel mounting (inner clearance 25 mm)

**NOTE:**  
Not suitable for concealed installation.

For details see page 106

Concealed rough parts

35 816 970 90 257,90

# Maro

Sieger Design



All Professional Information can also be found at [www.dornbracht.com](http://www.dornbracht.com).

33 800 795

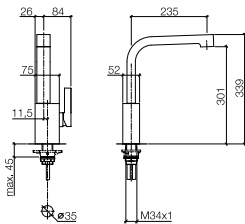

**Single-lever mixer**

- 235 mm projection
- pivotable spout 360°
- hole diameter 35 mm
- cartridge with ceramic discs
- 2x M 10 x 1 x 420 mm high pressure hose
- Max. flow 8 l/min at 3 bar flow pressure
- lead-free

		Euro
polished chrome	33 800 795-00	816,10
platinum matt	33 800 795-06	1.223,70

33 826 795 +  
27 714 970

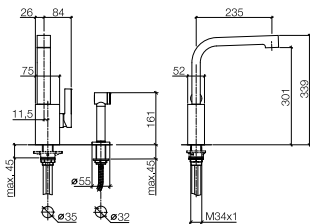

**Single-lever mixer with rinsing spray set**

- 235 mm projection
- pivotable spout 360°
- hole diameter rinsing spray 32 mm
- Single-lever mixer hole diameter 35 mm
- cartridge with ceramic discs
- 2x M 10 x 1 x 420 mm screw-in high pressure hose
- 1x M 10 x 1/2" x 420 mm high pressure hose
- fabric braided hose 1500 mm
- Max. flow 8 l/min at 3 bar flow pressure
- sprayface with anti-scaling system
- lead-free

Recommended minimum flow pressure: 2.5 bar.  
Intrinsic protection against back flow.

		Euro
polished chrome	1x 33 826 795-00	870,00
	1x 27 714 970-00	396,10
	<b>Total price:</b>	<b>1.266,10</b>
platinum matt	1x 33 826 795-06	1.305,10
	1x 27 714 970-06	594,20
	<b>Total price:</b>	<b>1.899,30</b>

**Recommended miscellaneous**



**Integrated washing-up liquid dispenser without rosette**  
For details see page 098



**Strainer waste with twist knob**  
For details see page 096



**Strainer waste, with electronic control**  
For details see page 097

33 826 795 +  
27 784 970



### Single-lever mixer with profi spray set

- 235 mm projection
- pivotable spout 360°
- Single-lever mixer hole diameter 35 mm
- Profi spray hole diameter 30 mm
- cartridge with ceramic discs
- 2x M 10 x 1/2" x 420 mm high pressure hose
- Max. flow 8 l/min at 3 bar flow pressure
- sprayface with anti-scaling system
- lead-free

Recommended minimum flow pressure: 2.5 bar.

Intrinsic protection against back flow.

		Euro
polished chrome	1x 33 826 795-00	870,00
	1x 27 784 970-00	944,50
	<b>Total price:</b>	<b>1.814,50</b>
platinum matt	1x 33 826 795-06	1.305,10
	1x 27 784 970-06	1.417,10
	<b>Total price:</b>	<b>2.722,20</b>

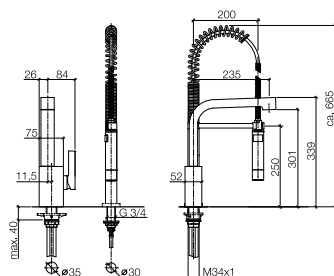

32 800 795



### Two-hole mixer with individual rosettes

- 235 mm projection
- pivotable spout 360°
- Mixer hole diameter 35 mm
- hole diameter spout 35 mm
- cartridge with ceramic discs
- 1x M 10 x 1/2" x 420 mm high pressure hose
- 2x M 10 x 1 x 420 mm high pressure hose
- Max. flow 8 l/min at 3 bar flow pressure
- lead-free

Operating unit can be positioned freely.

		Euro
polished chrome	32 800 795-00	965,40
platinum matt	32 800 795-06	1.448,30

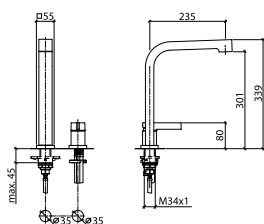

### Recommended miscellaneous



**Integrated washing-up liquid dispenser with rosette**

For details see page 098



**Strainer waste with control handle**

For details see page 096



**Strainer waste, with electronic control**

For details see page 097

32 800 795 +  
27 714 970

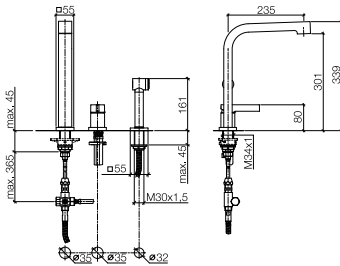

**Two-hole mixer with individual rosettes and rinsing spray set**

- 235 mm projection
- pivotable spout 360°
- hole diameter rinsing spray 32 mm
- Mixer hole diameter 35 mm
- hole diameter spout 35 mm
- cartridge with ceramic discs
- 1x M 10 x 1/2" x 420 mm high pressure hose
- 2x M 10 x 1 x 420 mm high pressure hose
- fabric braided hose 1500 mm
- Max. flow 8 l/min at 3 bar flow pressure
- sprayface with anti-scaling system
- lead-free

Recommended minimum flow pressure: 2.5 bar.

Intrinsic protection against back flow.

Operating unit can be positioned freely.

		Euro
polished chrome	1x 32 800 795-00	965,40
	1x 27 714 970-00	396,10
	<b>Total price:</b>	<b>1.361,50</b>
platinum matt	1x 32 800 795-06	1.448,30
	1x 27 714 970-06	594,20
	<b>Total price:</b>	<b>2.042,50</b>

32 800 795 +  
27 784 970

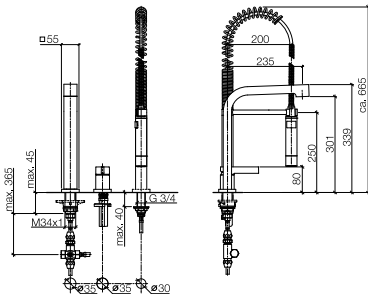

**Two-hole mixer with individual rosettes and Profi spray set**

- 235 mm projection
- pivotable spout 360°
- Profi spray hole diameter 30 mm
- Mixer hole diameter 35 mm
- hole diameter spout 35 mm
- cartridge with ceramic discs
- 2x M 10 x 1 x 420 mm high pressure hose
- 2x M 10 x 1/2" x 420 mm high pressure hose
- Max. flow 8 l/min at 3 bar flow pressure
- sprayface with anti-scaling system
- lead-free

Recommended minimum flow pressure: 2.5 bar.

Intrinsic protection against back flow.

Operating unit can be positioned freely.

		Euro
polished chrome	1x 32 800 795-00	965,40
	1x 27 784 970-00	944,50
	<b>Total price:</b>	<b>1.909,90</b>
platinum matt	1x 32 800 795-06	1.448,30
	1x 27 784 970-06	1.417,10
	<b>Total price:</b>	<b>2.865,40</b>

**Recommended miscellaneous**



**Integrated washing-up liquid dispenser without rosette**  
For details see page 098



**Strainer waste with twist knob**  
For details see page 096



**Strainer waste, with electronic control**  
For details see page 097

# Meta.02

Sieger Design



## Modifications 2015

Single-lever mixer **33 810 625-FF** and single-lever mixer **33 820 625-FF** are added to the series, for combining with side-mounted rinsing spray and profi spray sets (available immediately).

Single-mixer **33 800 625-FF** and single-mixer **33 826 625-FF** for combining with side-mounted rinsing spray and profi spray sets are withdrawn from the product range.

All Professional Information can also be found at [www.dornbracht.com](http://www.dornbracht.com).

33 810 625

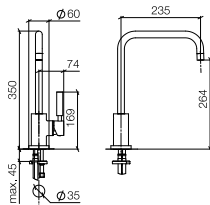

**Single-lever mixer**

- 235 mm projection
- pivotable spout 360°
- hole diameter 35 mm
- cartridge with ceramic discs
- 2x M 10 x 1 x 420 mm high pressure hose
- Max. flow 7 l/min at 3 bar flow pressure
- lead-free

		Euro
polished chrome	33 810 625-00	531,30
platinum matt	33 810 625-06	797,00

33 820 625 +  
27 719 970

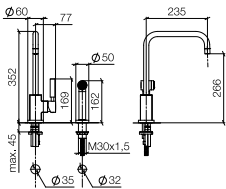

**Single-lever mixer with rinsing spray set**

- 235 mm projection
- pivotable spout 360°
- hole diameter rinsing spray 32 mm
- Single-lever mixer hole diameter 35 mm
- cartridge with ceramic discs
- 3x M 10 x 1 x 420 mm high pressure hose
- fabric braided hose 1500 mm
- sprayface with anti-scaling system
- Max. flow 7 l/min at 3 bar flow pressure
- lead-free

Intrinsic protection against back flow.  
Recommended minimum flow pressure: 2.5 bar.

		Euro
polished chrome	1x 33 820 625-00	531,30
	1x 27 719 970-00	365,20
	<b>Total price:</b>	<b>896,50</b>
platinum matt	1x 33 820 625-06	797,00
	1x 27 719 970-06	547,90
	<b>Total price:</b>	<b>1.344,90</b>

**Recommended miscellaneous**



**Integrated washing-up liquid  
dispenser without rosette**  
For details see page 099



**Strainer waste with control  
handle**  
For details see page 096



**Strainer waste, with electronic  
control**  
For details see page 097

33 820 625 +  
27 789 970

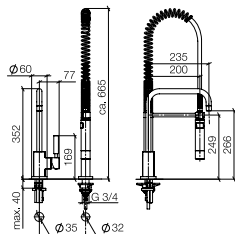

#### Single-lever mixer with profi spray set

- 235 mm projection
- pivotable spout 360°
- Single-lever mixer hole diameter 35 mm
- Profi spray hole diameter 30 mm
- cartridge with ceramic discs
- 3x M 10 x 1 x 420 mm high pressure hose
- 1x M 10 x 1/2" x 500 mm high pressure hose
- sprayface with anti-scaling system
- Max. flow 7 l/min at 3 bar flow pressure
- lead-free

Intrinsic protection against back flow.

Recommended minimum flow pressure: 2.5 bar.

		Euro
polished chrome	1x 33 820 625-00	531,30
	1x 27 789 970-00	891,60
	<b>Total price:</b>	<b>1.422,90</b>
platinum matt	1x 33 820 625-06	797,00
	1x 27 789 970-06	1.337,20
	<b>Total price:</b>	<b>2.134,20</b>

32 800 625

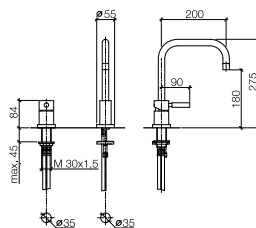

#### Two-hole mixer

- 200 mm projection
- pivotable spout 360°
- Mixer hole diameter 35 mm
- hole diameter spout 35 mm
- cartridge with ceramic discs
- 1x M 10 x 1/2" x 420 mm high pressure hose
- 3x M 10 x 1 x 420 mm high pressure hose
- Max. flow 8 l/min at 3 bar flow pressure
- lead-free

Operating unit can be positioned freely.

		Euro
polished chrome	32 800 625-00	591,50
platinum matt	32 800 625-06	886,90

#### Recommended miscellaneous



**Integrated washing-up liquid dispenser with rosette**  
For details see page 099



**Strainer waste with control handle**  
For details see page 096



**Strainer waste, with electronic control**  
For details see page 097

32 800 625 +  
27 719 970



Two-hole mixer with rinsing spray set

- 200 mm projection
- pivotable spout 360°
- hole diameter rinsing spray 32 mm
- Mixer hole diameter 35 mm
- hole diameter spout 35 mm
- cartridge with ceramic discs
- 1x M 10 x 1/2" x 420 mm high pressure hose
- 3x M 10 x 1 x 420 mm high pressure hose
- fabric braided hose 1500 mm
- Max. flow 8 l/min at 3 bar flow pressure
- sprayface with anti-scaling system
- lead-free

Intrinsic protection against back flow.

Recommended minimum flow pressure: 2.5 bar.

Operating unit can be positioned freely.

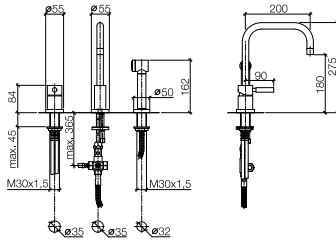

		Euro
polished chrome	1x 32 800 625-00	591,50
	1x 27 719 970-00	365,20
Total price:		956,70
platinum matt	1x 32 800 625-06	886,90
	1x 27 719 970-06	547,90
Total price:		1.434,80

32 800 625 +  
27 789 970



Two-hole mixer with profi spray set

- 200 mm projection
- pivotable spout 360°
- Profi spray hole diameter 30 mm
- Mixer hole diameter 35 mm
- hole diameter spout 35 mm
- cartridge with ceramic discs
- 1x M 10 x 1/2" x 420 mm high pressure hose
- 3x M 10 x 1 x 420 mm high pressure hose
- 1x pressure hose 1/2" male x Ø 10 x 500 mm
- Max. flow 8 l/min at 3 bar flow pressure
- sprayface with anti-scaling system
- lead-free

Intrinsic protection against back flow.

Recommended minimum flow pressure: 2.5 bar.

Operating unit can be positioned freely.

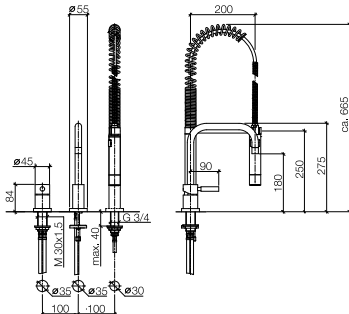

		Euro
polished chrome	1x 32 800 625-00	591,50
	1x 27 789 970-00	891,60
Total price:		1.483,10
platinum matt	1x 32 800 625-06	886,90
	1x 27 789 970-06	1.337,20
Total price:		2.224,10

Recommended miscellaneous



Integrated washing-up liquid  
dispenser with rosette  
For details see page 099



Strainer waste with control  
handle  
For details see page 096



Strainer waste, with electronic  
control  
For details see page 097

32 815 625

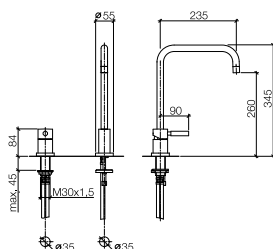
**Two-hole mixer**

- 235 mm projection
- pivotable spout 360°
- Mixer hole diameter 35 mm
- hole diameter spout 35 mm
- cartridge with ceramic discs
- 1x M 10 x 1/2" x 420 mm high pressure hose
- 3x M 10 x 1 x 420 mm high pressure hose
- Max. flow 8 l/min at 3 bar flow pressure
- lead-free

Operating unit can be positioned freely.

		Euro
polished chrome	32 815 625-00	656,40
platinum matt	32 815 625-06	984,50

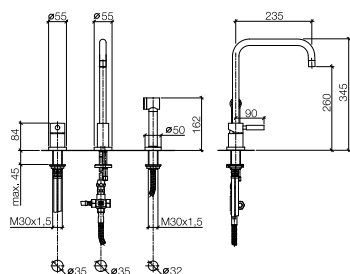
32 815 625 +  
27 719 970**Two-hole mixer with rinsing spray set**

- 235 mm projection
- pivotable spout 360°
- hole diameter rinsing spray 32 mm
- Mixer hole diameter 35 mm
- hole diameter spout 35 mm
- cartridge with ceramic discs
- 1x M 10 x 1/2" x 420 mm high pressure hose
- 3x M 10 x 1 x 420 mm high pressure hose
- fabric braided hose 1500 mm
- Max. flow 8 l/min at 3 bar flow pressure
- sprayface with anti-scaling system
- lead-free

Intrinsic protection against back flow.

Recommended minimum flow pressure: 2.5 bar.

Operating unit can be positioned freely.

		Euro
polished chrome	1x 32 815 625-00	656,40
	1x 27 719 970-00	365,20
	<b>Total price:</b>	<b>1.021,60</b>
platinum matt	1x 32 815 625-06	984,50
	1x 27 719 970-06	547,90
	<b>Total price:</b>	<b>1.532,40</b>

**Recommended miscellaneous**

**Integrated washing-up liquid dispenser with rosette**  
For details see page 099



**Strainer waste with control handle**  
For details see page 096



**Strainer waste, with electronic control**  
For details see page 097

32 815 625 +  
27 789 970



Two-hole mixer with profi spray set

- 235 mm projection
- pivotable spout 360°
- Profi spray hole diameter 30 mm
- Mixer hole diameter 35 mm
- hole diameter spout 35 mm
- cartridge with ceramic discs
- 3x M 10 x 1 x 420 mm high pressure hose
- 2x M 10 x 1/2" x 420 mm high pressure hose
- Max. flow 8 l/min at 3 bar flow pressure
- sprayface with anti-scaling system
- lead-free

Intrinsic protection against back flow.

Recommended minimum flow pressure: 2.5 bar.

Operating unit can be positioned freely.

		Euro
polished chrome	1 x 32 815 625-00	656,40
	1 x 27 789 970-00	891,60
Total price:		1.548,00
platinum matt	1 x 32 815 625-06	984,50
	1 x 27 789 970-06	1.337,20
Total price:		2.321,70

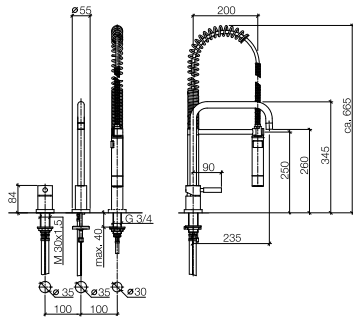

Recommended miscellaneous



Integrated washing-up liquid  
dispenser with rosette  
For details see page 099



Strainer waste with control  
handle  
For details see page 096



Strainer waste, with electronic  
control  
For details see page 097

36 834 625

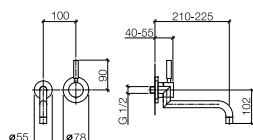
**Wall-mounted mixer with individual rosettes****Exposed trim parts****• 225 mm projection**

- pivotable spout
- Max. flow 7 l/min at 3 bar flow pressure
- lead-free

Mixer can be placed above, to the right or to the left of the spout.

		Euro
polished chrome	36 834 625-00	666,50
platinum matt	36 834 625-06	999,70



## Required miscellaneous

## Euro

**Concealed body, mixer on right**

- Min. recess depth 59 mm

For details see page 104

Concealed rough parts

35 806 970 90 225,40



## Required miscellaneous

## Euro

**Concealed body, mixer on left**

- Min. recess depth 59 mm

For details see page 104

Concealed rough parts

35 807 970 90 225,40



## Required miscellaneous

## Euro

**Concealed body, mixer at top**

- Min. recess depth 59 mm

For details see page 105

Concealed rough parts

35 808 970 90 225,40



## Required miscellaneous

## Euro

**Wall-mounted mixer, mixer on right**

for back panel mounting (inner clearance 25 mm)

**NOTE:**

**Not suitable for concealed installation.**

For details see page 106

Concealed rough parts

35 816 970 90 257,90



## Optional miscellaneous

## Euro

**Cover plate**

- size 83 x 183 x 9 mm

polished chrome

12 650 970-00 266,50

platinum matt

12 650 970-06 426,30

36 838 625

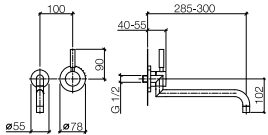

Wall-mounted mixer with individual rosettes

Exposed trim parts

• 300 mm projection

- pivotable spout
- Max. flow 7 l/min at 3 bar flow pressure
- lead-free

Mixer can be placed above, to the right or to the left of the spout.

		Euro
polished chrome	36 838 625-00	708,90
platinum matt	36 838 625-06	1.063,60



Required miscellaneous

Concealed body, mixer on right

- Min. recess depth 59 mm

For details see page 104

		Euro
Concealed rough parts	35 806 970 90	225,40



Required miscellaneous

Concealed body, mixer on left

- Min. recess depth 59 mm

For details see page 104

		Euro
Concealed rough parts	35 807 970 90	225,40



Required miscellaneous

Concealed body, mixer at top

- Min. recess depth 59 mm

For details see page 105

		Euro
Concealed rough parts	35 808 970 90	225,40



Required miscellaneous

Wall-mounted mixer, mixer on right

for back panel mounting (inner clearance 25 mm)

NOTE:

Not suitable for concealed installation.

For details see page 106

		Euro
Concealed rough parts	35 816 970 90	257,90



Optional miscellaneous

Cover plate

- size 83 x 183 x 9 mm

		Euro
polished chrome	12 650 970-00	266,50
platinum matt	12 650 970-06	426,30

36 851 625

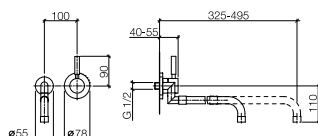
**Wall-mounted mixer with individual rosettes****Exposed trim parts****• 495 mm projection**

- extending spout
- pivotable spout
- Max. flow 7 l/min at 3 bar flow pressure
- without aerator
- lead-free

Mixer can be placed above, to the right or to the left of the spout.

		Euro
polished chrome	36 851 625-00	722,00
platinum matt	36 851 625-06	1.083,00



## Required miscellaneous

## Euro

**Concealed body, mixer on right**

- Min. recess depth 59 mm

For details see page 104

Concealed rough parts

35 806 970 90

225,40



## Required miscellaneous

## Euro

**Concealed body, mixer on left**

- Min. recess depth 59 mm

For details see page 104

Concealed rough parts

35 807 970 90

225,40



## Required miscellaneous

## Euro

**Concealed body, mixer at top**

- Min. recess depth 59 mm

For details see page 105

Concealed rough parts

35 808 970 90

225,40



## Required miscellaneous

## Euro

**Wall-mounted mixer, mixer on right**

for back panel mounting (inner clearance 25 mm)

**NOTE:**

**Not suitable for concealed installation.**

For details see page 106

Concealed rough parts

35 816 970 90

257,90



## Optional miscellaneous

## Euro

**Cover plate**

- size 83 x 183 x 9 mm

polished chrome

12 650 970-00

266,50

platinum matt

12 650 970-06

426,30



# Tara Classic

Sieger Design



All Professional Information can also be found at [www.dornbracht.com](http://www.dornbracht.com).

33 800 888

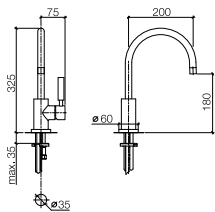

Single-lever mixer

- 200 mm projection
- pivotable spout 360°
- hole diameter 35 mm
- cartridge with ceramic discs
- 2x M 10 x 1 x 420 mm high pressure hose
- Max. flow 7 l/min at 3 bar flow pressure
- lead-free

		Euro
polished chrome	33 800 888-00	580,80
platinum matt	33 800 888-06	871,10

33 815 888

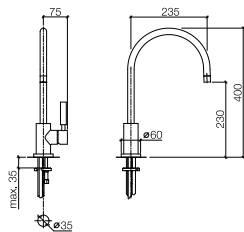

Single-lever mixer

- 235 mm projection
- pivotable spout 360°
- hole diameter 35 mm
- cartridge with ceramic discs
- 2x M 10 x 1 x 420 mm high pressure hose
- Max. flow 7 l/min at 3 bar flow pressure
- lead-free

		Euro
polished chrome	33 815 888-00	580,80
platinum matt	33 815 888-06	871,10
cyprum	33 815 888-49	1.161,60

Recommended miscellaneous



Integrated washing-up liquid dispenser with rosette  
For details see page 099



Strainer waste with control handle  
For details see page 096



Strainer waste, with electronic control  
For details see page 097

33 855 888

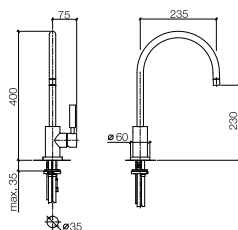

### Single-lever mixer for open hot-water boilers (low pressure)

- 235 mm projection
- pivotable spout 360°
- hole diameter 35 mm
- cartridge with ceramic discs
- 2x M 10 x 3/8" x 500 mm high pressure hose
- 1x M 10 x 3/8" x 420 mm high pressure hose
- Max. flow 7 l/min at 3 bar flow pressure
- lead-free



		Euro
polished chrome	33 855 888-00	658,40
platinum matt	33 855 888-06	987,80

33 826 888 +  
27 718 970

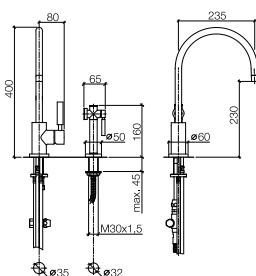

### Single-lever mixer with rinsing spray set

- 235 mm projection
- pivotable spout 360°
- hole diameter rinsing spray 32 mm
- Single-lever mixer hole diameter 35 mm
- cartridge with ceramic discs
- 3x M 10 x 1 x 420 mm high pressure hose
- fabric braided hose 1500 mm
- Max. flow 7 l/min at 3 bar flow pressure
- sprayface with anti-scaling system
- lead-free

Intrinsic protection against back flow.

Recommended minimum flow pressure: 2.5 bar.

		Euro
polished chrome	1x 33 826 888-00	570,10
	1x 27 718 970-00	381,90
	<b>Total price:</b>	<b>952,00</b>
platinum matt	1x 33 826 888-06	855,00
	1x 27 718 970-06	572,80
	<b>Total price:</b>	<b>1.427,80</b>
cyprum	1x 33 826 888-49	1.140,10
	1x 27 718 970-49	763,80
	<b>Total price:</b>	<b>1.903,90</b>

### Recommended miscellaneous



**Integrated washing-up liquid dispenser with rosette**  
For details see page 099



**Strainer waste with control handle**  
For details see page 096



**Strainer waste, with electronic control**  
For details see page 097

$$\begin{array}{r} 33\ 826\ 888 + \\ 27\ 780\ 970 \\ \hline \end{array}$$

### Single-lever mixer with profi spray set

- **235 mm projection**
- pivotable spout 360°
- Single-lever mixer hole diameter 35 mm
- Profi spray hole diameter 30 mm
- cartridge with ceramic discs
- 3x M 10 x 1 x 420 mm high pressure hose
- 1x M 10 x 1/2" x 500 mm high pressure hose
- sprayface with anti-scaling system
- Max. flow 7 l/min at 3 bar flow pressure
- lead-free

Intrinsic protection against back flow.

Recommended minimum flow pressure: 2.5 bar.

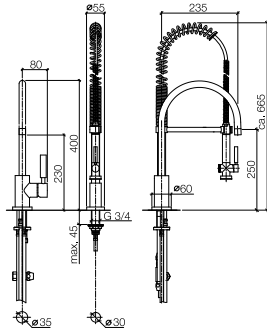

		<b>Euro</b>
polished chrome	<b>1x 33 826 888-00</b>	570,10
	<b>1x 27 780 970-00</b>	817,60
	<b>Total price:</b>	<b>1.387,70</b>
platinum matt	<b>1x 33 826 888-06</b>	855,00
	<b>1x 27 780 970-06</b>	1.226,40
	<b>Total price:</b>	<b>2.081,40</b>

33 880 888



### Profi single-lever mixer

- **200 mm projection**
- **pivotable spout 360°**
- **hole diameter 35 mm**
- **cartridge with ceramic discs**
- **sprayface with anti-scaling system**
- **Max. flow 7 l/min at 3 bar flow pressure**
- **lead-free**

Recommended minimum flow pressure: 2.5 bar.

Intrinsic protection against back flow.

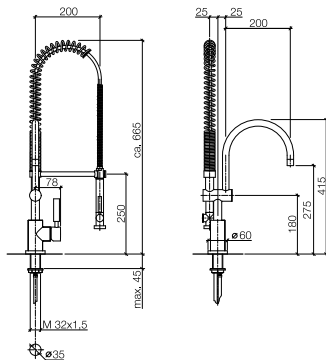

		Euro
polished chrome	33 880 888-00	1.205,10
platinum matt	33 880 888-06	1.807,50

### Recommended miscellaneous



Integrated washing-up liquid dispenser with rosette

For details see page 099



**Strainer waste with control handle**

For details see page 096



Strainer waste, with electronic control

For details see page 097

33 880 889

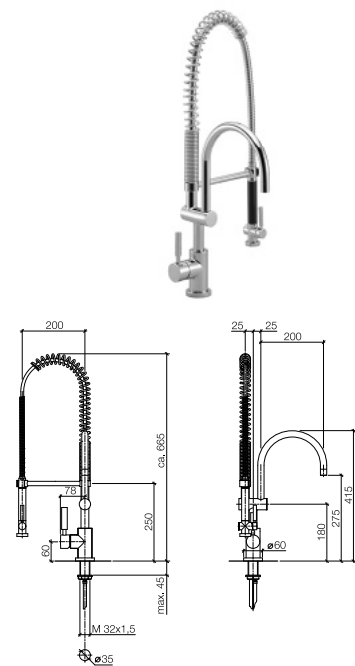

**Profi single-lever mixer with lever on left**

- 200 mm projection
- pivotable spout 360°
- hole diameter 35 mm
- cartridge with ceramic discs
- sprayface with anti-scaling system
- Max. flow 7 l/min at 3 bar flow pressure
- lead-free

Recommended minimum flow pressure: 2.5 bar.  
Intrinsic protection against back flow.

		Euro
polished chrome	33 880 889-00	1.205,10
platinum matt	33 880 889-06	1.807,50

**Recommended miscellaneous**



**Integrated washing-up liquid dispenser with rosette**  
For details see page 099



**Strainer waste with control handle**  
For details see page 096



**Strainer waste, with electronic control**  
For details see page 097



# Tara.

Sieger Design



All Professional Information can also be found at [www.dornbracht.com](http://www.dornbracht.com).

22 815 892

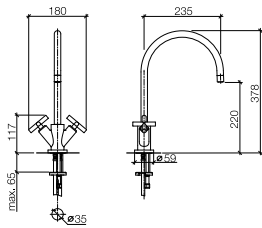

**Single-hole mixer**

- 235 mm projection
- pivotable spout 360°
- hole diameter 35 mm
- 2x 1/2" ceramic head part
- 2x M 10 x 1 x 420 mm high pressure hose
- Max. flow 7 l/min at 3 bar flow pressure
- lead-free

		Euro
polished chrome	22 815 892-00	407,90
platinum matt	22 815 892-06	611,80
cyprum	22 815 892-49	815,80

19 815 892

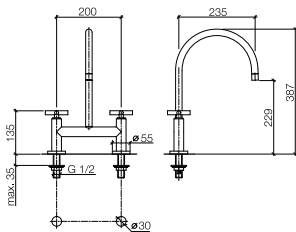

**Two-hole bridge mixer**

- 235 mm projection
- pivotable spout 360°
- gauge 200 mm
- hole diameter 30 mm
- 2x 1/2" ceramic head part
- Max. flow 7 l/min at 3 bar flow pressure
- lead-free

		Euro
polished chrome	19 815 892-00	714,10
platinum matt	19 815 892-06	1.071,60

**Recommended miscellaneous**



**Integrated washing-up liquid dispenser with rosette**  
For details see page 099



**Strainer waste with control handle**  
For details see page 096



**Strainer waste, with electronic control**  
For details see page 097

20 815 892

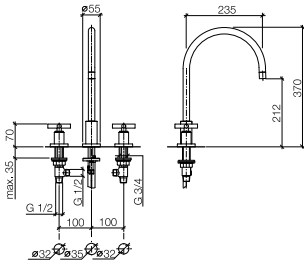

Three-hole mixer

- 235 mm projection
- pivotable spout 360°
- hole diameter spout 35 mm
- Deck valve hole diameter 32 mm
- 1/2" deck valves with ceramic head parts
- 2x M 10 x 1 x 420 mm high pressure hose
- Max. flow 7 l/min at 3 bar flow pressure
- lead-free

		Euro
polished chrome	20 815 892-00	765,20
platinum matt	20 815 892-06	1.148,00
cyprum	20 815 892-49	1.530,60

20 815 892 +  
27 718 970

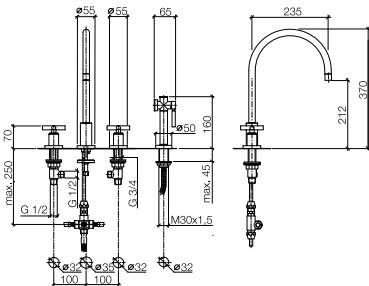

Three-hole mixer with rinsing spray set

- 235 mm projection
- pivotable spout 360°
- hole diameter rinsing spray 32 mm
- hole diameter spout 35 mm
- Deck valve hole diameter 32 mm
- 1/2" deck valves with ceramic head parts
- 2x M 10 x 1 x 420 mm high pressure hose
- 2x 1/2" x 1/2" x 300 mm high pressure hose
- fabric braided hose 1500 mm
- Max. flow 7 l/min at 3 bar flow pressure
- sprayface with anti-scaling system
- lead-free

Intrinsic protection against back flow.  
Recommended minimum flow pressure: 2.5 bar.

		Euro
polished chrome	1x 20 815 892-00	765,20
	1x 27 718 970-00	381,90
	<b>Total price:</b>	<b>1.147,10</b>
platinum matt	1x 20 815 892-06	1.148,00
	1x 27 718 970-06	572,80
	<b>Total price:</b>	<b>1.720,80</b>
cyprum	1x 20 815 892-49	1.530,60
	1x 27 718 970-49	763,80
	<b>Total price:</b>	<b>2.294,40</b>

Recommended miscellaneous



Integrated washing-up liquid  
dispenser with rosette  
For details see page 099



Strainer waste with control  
handle  
For details see page 096



Strainer waste, with electronic  
control  
For details see page 097

20 815 892 +  
27 780 970

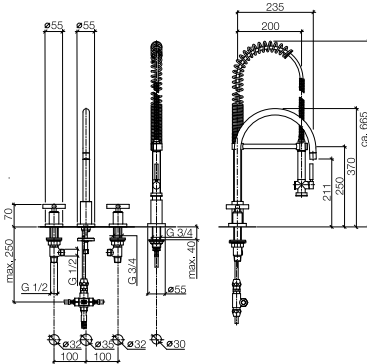

### Three-hole mixer with profi spray set

- 235 mm projection
- pivotable spout 360°
- hole diameter spout 35 mm
- Profi spray hole diameter 30 mm
- Deck valve hole diameter 32 mm
- 1/2" deck valves with ceramic head parts
- 2x M 10 x 1 x 420 mm high pressure hose
- 2x 1/2" x 1/2" x 300 mm high pressure hose
- 1x M 10 x 1/2" x 500 mm high pressure hose
- sprayface with anti-scaling system
- Max. flow 7 l/min at 3 bar flow pressure
- lead-free

Intrinsic protection against back flow.

Recommended minimum flow pressure: 2.5 bar.

		Euro
polished chrome	1 x 20 815 892-00	765,20
	1 x 27 780 970-00	817,60
	<b>Total price:</b>	<b>1.582,80</b>
platinum matt	1 x 20 815 892-06	1.148,00
	1 x 27 780 970-06	1.226,40
	<b>Total price:</b>	<b>2.374,40</b>

20 815 882

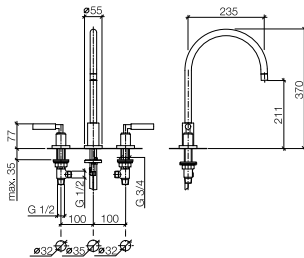

### Three-hole mixer

- 235 mm projection
- pivotable spout 360°
- hole diameter spout 35 mm
- Deck valve hole diameter 32 mm
- 1/2" deck valves with ceramic head parts
- 2x M 10 x 1 x 420 mm high pressure hose
- Max. flow 7 l/min at 3 bar flow pressure
- lead-free

		Euro
polished chrome	20 815 882-00	834,90
platinum matt	20 815 882-06	1.252,60

### Recommended miscellaneous



**Integrated washing-up liquid dispenser with rosette**  
For details see page 099



**Strainer waste with control handle**  
For details see page 096



**Strainer waste, with electronic control**  
For details see page 097

20 815 882 +  
27 718 970

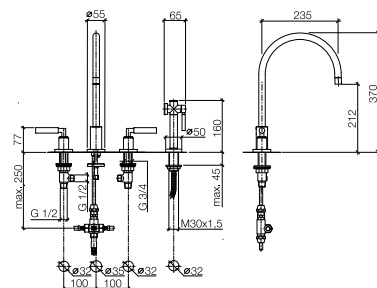

### Three-hole mixer with rinsing spray set

- 235 mm projection
- pivotable spout 360°
- hole diameter rinsing spray 32 mm
- hole diameter spout 35 mm
- Deck valve hole diameter 32 mm
- 1/2" deck valves with ceramic head parts
- 2x M 10 x 1 x 420 mm high pressure hose
- 2x 1/2" x 1/2" x 300 mm high pressure hose
- fabric braided hose 1500 mm
- sprayface with anti-scaling system
- Max. flow 7 l/min at 3 bar flow pressure
- lead-free

Intrinsic protection against back flow.

Recommended minimum flow pressure: 2.5 bar.

		Euro
polished chrome	1x 20 815 882-00	834,90
	1x 27 718 970-00	381,90
	<b>Total price:</b>	<b>1.216,80</b>
platinum matt	1x 20 815 882-06	1.252,60
	1x 27 718 970-06	572,80
	<b>Total price:</b>	<b>1.825,40</b>

20 815 882 +  
27 780 970

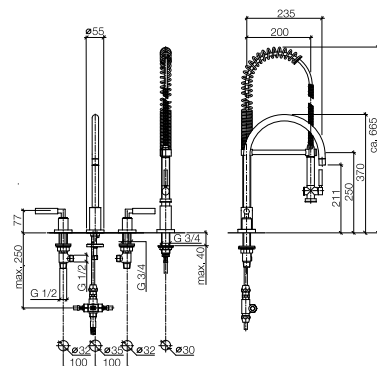

### Three-hole mixer with profi spray set

- 235 mm projection
- pivotable spout 360°
- hole diameter spout 35 mm
- Profi spray hole diameter 30 mm
- Deck valve hole diameter 32 mm
- 1/2" deck valves with ceramic head parts
- 2x M 10 x 1 x 420 mm high pressure hose
- 2x 1/2" x 1/2" x 300 mm high pressure hose
- 1x M 10 x 1/2" x 500 mm high pressure hose
- sprayface with anti-scaling system
- Max. flow 7 l/min at 3 bar flow pressure
- lead-free

Intrinsic protection against back flow.

Recommended minimum flow pressure: 2.5 bar.

		Euro
polished chrome	1x 20 815 882-00	834,90
	1x 27 780 970-00	817,60
	<b>Total price:</b>	<b>1.652,50</b>
platinum matt	1x 20 815 882-06	1.252,60
	1x 27 780 970-06	1.226,40
	<b>Total price:</b>	<b>2.479,00</b>

## Recommended miscellaneous



**Integrated washing-up liquid dispenser with rosette**  
For details see page 099



**Strainer waste with control handle**  
For details see page 096



**Strainer waste, with electronic control**  
For details see page 097

31 151 892



**Wall-mounted bridge mixer with extending spout**

- 365-545 mm projection
- pivotable spout
- 2x 1/2" ceramic head part
- special S connectors
- Max. flow 8 l/min at 3 bar flow pressure
- without aerator
- lead-free

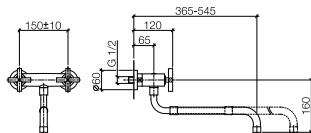

		Euro
polished chrome	31 151 892-00	738,40
platinum matt	31 151 892-06	1.107,50

30 151 892



**Tap with pivotable spout with extending spout**

- 315-485 mm projection
- pivotable spout
- 1/2" ceramic head part
- Max. flow 7 l/min at 3 bar flow pressure
- without aerator
- lead-free

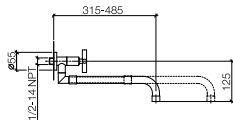

		Euro
polished chrome	30 151 892-00	381,70
platinum matt	30 151 892-06	572,60

36 818 892

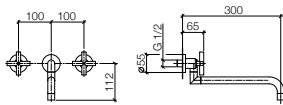



Wall-mounted sink mixer

Exposed trim parts

- 300 mm projection
- pivotable spout
- 2x ceramic head part 1/2", with spindle for shortening
- Max. flow 7 l/min at 3 bar flow pressure
- lead-free

		Euro
polished chrome	36 818 892-00	852,90
platinum matt	36 818 892-06	1.279,40
cyprum	36 818 892-49	1.705,80

Required miscellaneous		Euro
 <b>Concealed body, gauge 100 mm</b> <ul style="list-style-type: none"><li>• Min. recess depth 65 mm</li></ul> <b>spout on left</b> For details see page 106	Concealed rough parts	35 713 970 90 223,30

Required miscellaneous		Euro
 <b>Concealed body, gauge 100 mm</b> <ul style="list-style-type: none"><li>• Min. recess depth 70 mm</li></ul> <b>spout centred</b> For details see page 106	Concealed rough parts	35 707 970 90 223,30

Required miscellaneous		Euro
 <b>Concealed body, gauge 100 mm</b> <ul style="list-style-type: none"><li>• Min. recess depth 65 mm</li></ul> <b>spout on right</b> For details see page 107	Concealed rough parts	35 714 970 90 223,30

Required miscellaneous		Euro
 <b>Concealed body, gauge 100 mm</b> <ul style="list-style-type: none"><li>• Min. recess depth 65 mm</li></ul> For details see page 107	Concealed rough parts	35 712 970 90 197,10

36 819 892

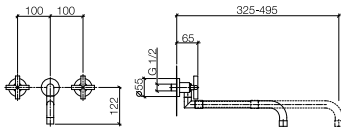



Wall-mounted sink mixer

- Exposed trim parts**
- 325-495 mm projection
  - pivotable spout
  - extending spout
  - 2x ceramic head part 1/2", with spindle for shortening
  - Max. flow 7 l/min at 3 bar flow pressure
  - lead-free

		Euro
polished chrome	36 819 892-00	865,80
platinum matt	36 819 892-06	1.298,40

			Euro
	<b>Concealed body, gauge 100 mm</b>	Concealed rough parts	
	• Min. recess depth 65 mm		
	<b>spout on left</b>		
	For details see page 106		
		35 713 970 90	223,30

			Euro
	<b>Concealed body, gauge 100 mm</b>	Concealed rough parts	
	• Min. recess depth 70 mm		
	<b>spout centred</b>		
	For details see page 106		
		35 707 970 90	223,30

			Euro
	<b>Concealed body, gauge 100 mm</b>	Concealed rough parts	
	• Min. recess depth 65 mm		
	<b>spout on right</b>		
	For details see page 107		
		35 714 970 90	223,30

			Euro
	<b>Concealed body, gauge 100 mm</b>	Concealed rough parts	
	• Min. recess depth 65 mm		
	For details see page 107		
		35 712 970 90	197,10

# Water Units

Sieger Design

## Double Units

from page 086

## Single Units

from page 089

## Cutting Boards

page 094



WATER UNITS are the first separate Dornbracht series of sinks for the kitchen. The series includes overmount and undermount single sink variants, as well as double sinks, specifically developed for combining with Dornbracht fittings. All WATER UNITS are hand-made stainless steel sinks and their specific design is geared to the requirements of the different areas of activity in the kitchen. The dimensions of the CUTTING BOARDS are an exact fit for the WATER UNITS and there are two variants available: One is for putting into the sink, or there is a larger version for placing onto the sink. Placing the chopping boards into or onto the sinks allows them to be used as work surfaces and encourages ergonomic working, because of their close proximity to the water point.

All Professional Information can also be found at [www.dornbracht.com](http://www.dornbracht.com).

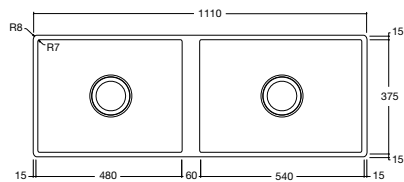



**Double sink 1110 mm x 405 mm**

- Sink depth 150 / 40 mm
- 3 1/2" closable strainer basket valve
- 3 1/2" non-lockable strainer basket valve
- complete pop-up waste and overflow, with valve bridge
- mounting kit
- suitable for 1200 mm base units (2 x 600 mm)

NOTE: This item is conditioned separately.  
Strainer waste not included in the scope of supply. For details see page 096.

		Euro
Installation, on top or flush		
38 511 000-86		3.030,10

				Euro
	Optional miscellaneous			
	<b>Cutting board</b>	black	84 700 000-13	218,40
	• for placing on	oak	84 700 000-48	328,70
For details see page 094				

				Euro
	Optional miscellaneous			
	<b>Cutting board with juice groove (carving board)</b>	black	84 750 000-13	166,40
	• for placing in	oak	84 750 000-48	219,50
For details see page 094				

				Euro
	Optional miscellaneous			
	<b>Cutting board</b>	black	84 751 000-13	125,70
	• for placing in	oak	84 751 000-48	183,00
For details see page 094				

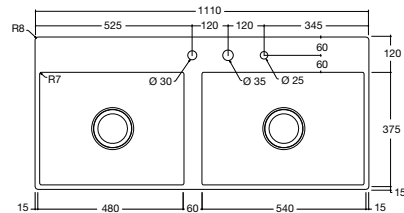
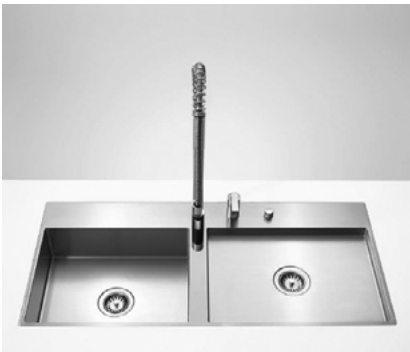



**Double sink with tap hole bank 1110 mm x 510 mm**

- Sink depth 150 / 40 mm
- 3 1/2" closable strainer basket valve
- 3 1/2" non-lockable strainer basket valve
- complete pop-up waste and overflow, with valve bridge
- mounting kit
- suitable for 1200 mm base units (2 x 600 mm)

NOTE: This item is conditioned separately.  
Strainer waste not included in the scope of supply. For details see page 096.

		Euro
Installation, on top or flush		
38 521 000-86		3.749,60

				Euro
	Optional miscellaneous			
	<b>Cutting board</b>	black	84 700 000-13	218,40
	• for placing on	oak	84 700 000-48	328,70
For details see page 094				

				Euro
	Optional miscellaneous			
	<b>Cutting board with juice groove (carving board)</b>	black	84 750 000-13	166,40
	• for placing in	oak	84 750 000-48	219,50
For details see page 094				

				Euro
	Optional miscellaneous			
	<b>Cutting board</b>	black	84 751 000-13	125,70
	• for placing in	oak	84 751 000-48	183,00
For details see page 094				

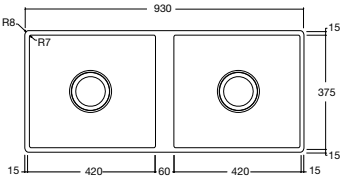

Double sink 930 mm x 405 mm

- Sink depth 200 / 200 mm
- 3 1/2" closable strainer basket valve
- 3 1/2" non-lockable strainer basket valve
- complete pop-up waste and overflow, with valve bridge
- mounting kit
- suitable for 1200 mm base units (2 x 600 mm)

NOTE: This item is conditioned separately.  
Strainer waste not included in the scope of supply. For details see page 096.

Euro		
Installation, on top or flush		
38 531 000-86	3.521,30	



Optional miscellaneous

Cutting board

- for placing on

For details see page 094

Euro		
black	84 700 000-13	218,40
oak	84 700 000-48	328,70

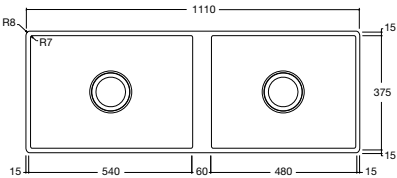

Double sink 1110 mm x 405 mm

- Sink depth 200 / 200 mm
- 3 1/2" closable strainer basket valve
- 3 1/2" non-lockable strainer basket valve
- complete pop-up waste and overflow, with valve bridge
- mounting kit
- suitable for 1200 mm base units (2 x 600 mm)

NOTE: This item is conditioned separately.  
Strainer waste not included in the scope of supply. For details see page 096.

Euro		
Installation, on top or flush		
38 541 000-86	3.602,50	

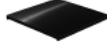

Optional miscellaneous

Cutting board

- for placing on

Euro		
black	84 700 000-13	218,40
oak	84 700 000-48	328,70

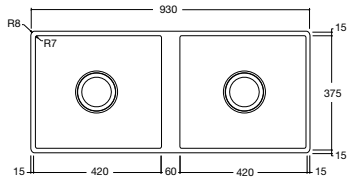

**Double sink 930 mm x 405 mm**

- Sink depth 200 / 40 mm
- 3 1/2" closable strainer basket valve
- 3 1/2" non-lockable strainer basket valve
- complete pop-up waste and overflow, with valve bridge
- mounting kit
- suitable for 1000 mm base units (2 x 500 mm)

NOTE: This item is conditioned separately.  
Strainer waste not included in the scope of supply. For details see page 096.

Euro		
Installation, on top or flush		
	38 561 000-86	2.660,30

Optional miscellaneous		Euro	
	<b>Cutting board</b>	black	84 700 000-13 218,40
	• for placing on	oak	84 700 000-48 328,70
For details see page 094			

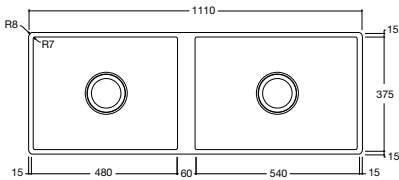



**Double sink 1110 mm x 405 mm**

- Sink depth 200 / 40 mm
- 3 1/2" closable strainer basket valve
- 3 1/2" non-lockable strainer basket valve
- complete pop-up waste and overflow, with valve bridge
- mounting kit
- suitable for 1200 mm base units (2 x 600 mm)

NOTE: This item is conditioned separately.  
Strainer waste not included in the scope of supply. For details see page 096.

Euro		
Installation, on top or flush		
	38 571 000-86	3.107,60

Optional miscellaneous		Euro	
	<b>Cutting board</b>	black	84 700 000-13 218,40
	• for placing on	oak	84 700 000-48 328,70
For details see page 094			

Optional miscellaneous		Euro	
	<b>Cutting board with juice groove (carving board)</b>	black	84 750 000-13 166,40
	• for placing in	oak	84 750 000-48 219,50
For details see page 094			

Optional miscellaneous		Euro	
	<b>Cutting board</b>	black	84 751 000-13 125,70
	• for placing in	oak	84 751 000-48 183,00
For details see page 094			

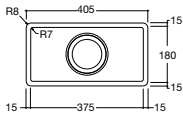

Single sink 210 mm x 405 mm

- Sink depth 40 mm
  - 3 1/2" non-lockable strainer basket valve
  - Complete pop-up waste, without valve bridge
  - mounting kit
  - suitable for 500 mm base units (2 x 250 mm)
- NOTE: This item is conditioned separately.

	Euro	
Installation, on top or flush	38 001 000-86	1.346,10
Under-mounted	38 000 000-86	1.119,00

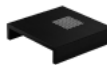

Optional miscellaneous

DRINKING PLATE

- for placing in the single sink
- For details see page 102

	Euro	
black	84 710 000-13	148,50

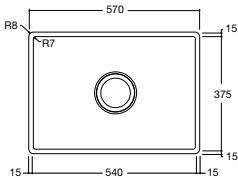

Single sink 570 mm x 405 mm

- Sink depth 40 mm
  - 3 1/2" non-lockable strainer basket valve
  - mounting kit
  - Complete pop-up waste, without valve bridge
  - suitable for 800 mm base units (2 x 400 mm)
- NOTE: This item is conditioned separately.

	Euro	
Installation, on top or flush	38 031 000-86	1.417,60
Under-mounted	38 030 000-86	1.182,10

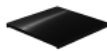

Optional miscellaneous

Cutting board

- for placing on
- For details see page 094

	Euro	
black	84 700 000-13	218,40
oak	84 700 000-48	328,70

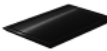

Optional miscellaneous

Cutting board with juice groove (carving board)

- for placing in
- For details see page 094

	Euro	
black	84 750 000-13	166,40
oak	84 750 000-48	219,50



Optional miscellaneous

Cutting board

- for placing in
- For details see page 094

	Euro	
black	84 751 000-13	125,70
oak	84 751 000-48	183,00

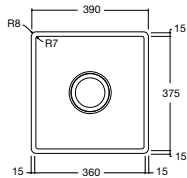

**Single sink 390 mm x 405 mm**

- Sink depth 150 mm
- 3 1/2" closable strainer basket valve
- complete pop-up waste and overflow, with valve bridge
- mounting kit
- suitable for 500 mm base units (2 x 250 mm)

NOTE: This item is conditioned separately.  
Strainer waste not included in the scope of supply. For details see page 096.

	Euro	
Installation, on top or flush		
	38 041 000-86	1.479,90
Under-mounted	38 040 000-86	1.232,50



Optional miscellaneous

**Cutting board**

- for placing on
- For details see page 094

	Euro	
black	84 700 000-13	218,40
oak	84 700 000-48	328,70

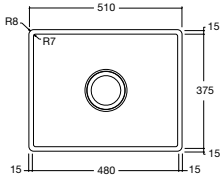

**Single sink 510 mm x 405 mm**

- Sink depth 150 mm
- 3 1/2" closable strainer basket valve
- complete pop-up waste and overflow, with valve bridge
- mounting kit
- suitable for 600 mm base units (2 x 300 mm)

NOTE: This item is conditioned separately.  
Strainer waste not included in the scope of supply. For details see page 096.

	Euro	
Installation, on top or flush		
	38 051 000-86	1.572,60
Under-mounted	38 050 000-86	1.304,60

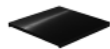

Optional miscellaneous

**Cutting board**

- for placing on
- For details see page 094

	Euro	
black	84 700 000-13	218,40
oak	84 700 000-48	328,70

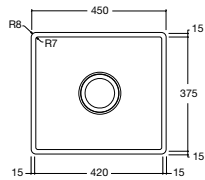

Single sink 450 mm x 405 mm

- Sink depth 200 mm
- 3 1/2" closable strainer basket valve
- complete pop-up waste and overflow, with valve bridge
- mounting kit
- suitable for 550 mm base units (2 x 275 mm)

NOTE: This item is conditioned separately.  
Strainer waste not included in the scope of supply. For details see page 096.

	Euro	
Installation, on top or flush	38 061 000-86	1.494,80
Under-mounted	38 060 000-86	1.325,80

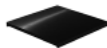

Optional miscellaneous

Cutting board

- for placing on
- For details see page 094

	Euro	
black	84 700 000-13	218,40
oak	84 700 000-48	328,70

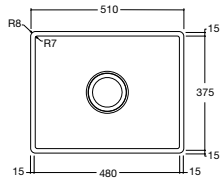

Single sink 510 mm x 405 mm

- Sink depth 200 mm
- 3 1/2" closable strainer basket valve
- complete pop-up waste and overflow, with valve bridge
- mounting kit
- suitable for 600 mm base units (2 x 300 mm)

NOTE: This item is conditioned separately.  
Strainer waste not included in the scope of supply. For details see page 096.

	Euro	
Installation, on top or flush	38 081 000-86	1.630,70
Under-mounted	38 080 000-86	1.452,50

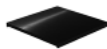

Optional miscellaneous

Cutting board

- for placing on
- For details see page 094

	Euro	
black	84 700 000-13	218,40
oak	84 700 000-48	328,70

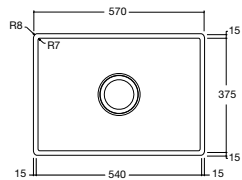

**Single sink 570 mm x 405 mm**

- Sink depth 200 mm
- 3 1/2" closable strainer basket valve
- complete pop-up waste and overflow, with valve bridge
- mounting kit
- suitable for 800 mm base units (2 x 400 mm)

NOTE: This item is conditioned separately.  
Strainer waste not included in the scope of supply. For details see page 096.

	Euro	
Installation, on top or flush		
	<b>38 091 000-86</b>	<b>1.657,70</b>
Under-mounted	<b>38 090 000-86</b>	<b>1.480,90</b>

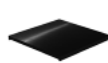

Optional miscellaneous

**Cutting board**

- for placing on
- For details see page 094

	Euro	
black	<b>84 700 000-13</b>	<b>218,40</b>
oak	<b>84 700 000-48</b>	<b>328,70</b>

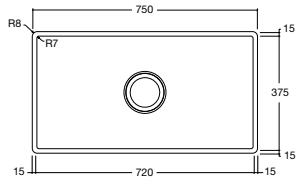

**Single sink 750 mm x 405 mm**

- Sink depth 200 mm
- 3 1/2" closable strainer basket valve
- complete pop-up waste and overflow, with valve bridge
- mounting kit
- suitable for 900 mm base units (2 x 450 mm)

NOTE: This item is conditioned separately.  
Strainer waste not included in the scope of supply. For details see page 096.

	Euro	
Installation, on top or flush		
	<b>38 101 000-86</b>	<b>1.721,30</b>
Under-mounted	<b>38 100 000-86</b>	<b>1.544,50</b>



Optional miscellaneous

**Cutting board**

- for placing on
- For details see page 094

	Euro	
black	<b>84 700 000-13</b>	<b>218,40</b>
oak	<b>84 700 000-48</b>	<b>328,70</b>

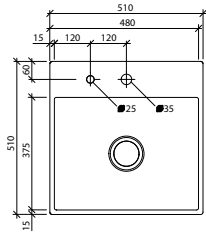

**Single sink with tap hole bank, 510 mm x 510 mm**

- Sink depth 200 mm
- 3 1/2" closable strainer basket valve
- complete pop-up waste and overflow, with valve bridge
- suitable for 600 mm base units (2 x 300 mm)
- mounting kit

NOTE: This item is conditioned separately.

Strainer waste not included in the scope of supply. For details see page 096.

Euro		
Installation, on top or flush		
	<b>38 111 000-86</b>	<b>1.739,10</b>

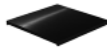

Optional miscellaneous

**Cutting board**

- for placing on

For details see page 094

Euro		
black	<b>84 700 000-13</b>	<b>218,40</b>
oak	<b>84 700 000-48</b>	<b>328,70</b>

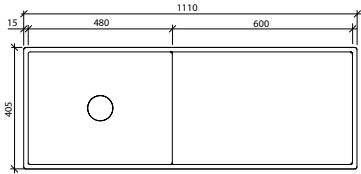

**Single sink with drainer, 1110 mm x 405 mm**

- Sink depth 200 mm
- 3 1/2" closable strainer basket valve
- complete pop-up waste and overflow, with valve bridge
- mounting kit
- suitable for 1200 mm base units (2 x 600 mm)

NOTE: This item is conditioned separately.

Strainer waste not included in the scope of supply. For details see page 096.

Euro		
Installation, on top or flush		
	<b>38 401 000-86</b>	<b>2.657,40</b>

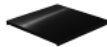

Optional miscellaneous

**Cutting board**

- for placing on

For details see page 094

Euro		
black	<b>84 700 000-13</b>	<b>218,40</b>
oak	<b>84 700 000-48</b>	<b>328,70</b>

84 700 000

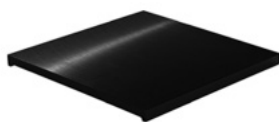

## Cutting board

- **Plastic 440 x 440 x 30 mm**
- non-slip
- kind to knives
- for placing over the sink
- dishwasher-safe
- Pack with colour marking pegs (black, red, blue, green, yellow)
- can be combined with all Water Units

NOTE: This item is conditioned separately.

			<b>Euro</b>
black	84 700 000-13		218,40

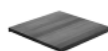

## 84 700 000 Product variants

### Cutting board

- **Wood 440 x 440 x 30 mm**
- oiled oak
- not dishwasher-safe

			<b>Euro</b>
oak	84 700 000-48		328,70

84 750 000

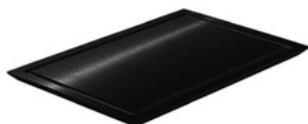

## Cutting board with juice groove (carving board)

- **Plastic 335 x 500 x 23 mm**
- non-slip
- kind to knives
- to match cutting board 84 751 000
- dishwasher-safe
- all-round juice groove

for placing in the sink (38 511 000-86 / 38 521 000-86 / 38 571 000-86 / 38 031 000-86 / 38 030 000-86)

NOTE: This item is conditioned separately.

			<b>Euro</b>
black	84 750 000-13		166,40



## 84 750 000 Product variants

### Cutting board with juice groove (carving board)

- **Wood 335 x 500 x 23 mm**
- oiled oak
- not dishwasher-safe

			<b>Euro</b>
oak	84 750 000-48		219,50

84 751 000

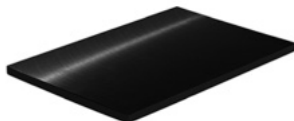

## Cutting board

- **Plastic 335 x 500 x 23 mm**
- non-slip
- kind to knives
- to match cutting board with juice groove 84 750 000
- dishwasher-safe
- Pack with colour marking pegs (black, red, blue, green, yellow)

for placing in the sink (38 511 000-86 / 38 521 000-86 / 38 571 000-86 / 38 031 000-86 / 38 030 000-86)

NOTE: This item is conditioned separately.

			<b>Euro</b>
black	84 751 000-13		125,70



## 84 751 000 Product variants

### Cutting board

- **Wood 335 x 500 x 23 mm**
- oiled oak
- not dishwasher-safe

			<b>Euro</b>
oak	84 751 000-48		183,00

# Generic miscellaneous



# Generic miscellaneous

10 710 970

**Strainer waste with control handle**

- control for single basin
- including adapter for Bowden cable

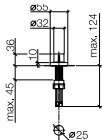

		Euro
polished chrome	10 710 970-00	129,20
platinum matt	10 710 970-06	193,70
cyprum	10 710 970-49	258,30

10 711 970

**Strainer waste with twist knob**

- control for single basin
- including adapter for Bowden cable

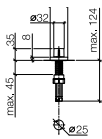

		Euro
polished chrome	10 711 970-00	129,20
platinum matt	10 711 970-06	193,70

10 712 970

**Strainer waste with control handle**

- control for single basin
- including adapter for Bowden cable

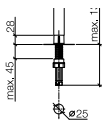

		Euro
polished chrome	10 712 970-00	129,20
platinum matt	10 712 970-06	193,70

10 731 970



**Strainer waste, with electronic control**

- integrated light ring (blue)
- spacer for waste connection
- power pack 230 V
- electronic strainer waste valve (motor and board) including pre-installed cabling
- pushbutton with angular rosette

		Euro
polished chrome	10 731 970-00	579,60
platinum matt	10 731 970-06	631,50

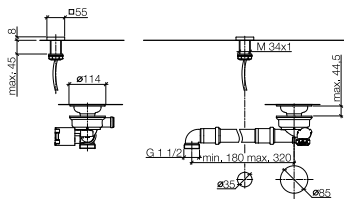

10 730 970



**Strainer waste, with electronic control**

- integrated light ring (blue)
- spacer for waste connection
- power pack 230 V
- pushbutton with round rosette
- electronic strainer waste valve (motor and board) including pre-installed cabling

		Euro
polished chrome	10 730 970-00	579,60
platinum matt	10 730 970-06	631,50

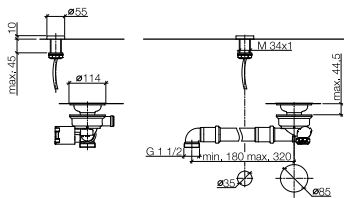

10 713 970



**AIR SWITCH (control button)**

- for controlling a waste disposal unit
- Compatible with waste disposal units made by Insinkerator®.
- The products are not available in all markets, please contact your Dornbracht sales force.
- For more information go to [www.insinkerator.com](http://www.insinkerator.com)

		Euro
polished chrome	10 713 970-00	91,10
platinum matt	10 713 970-06	136,60
cyprum	10 713 970-49	182,20

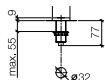

# Generic miscellaneous

10 714 970



## AIR SWITCH (control button)

- for controlling a waste disposal unit
- Compatible with waste disposal units made by Insinkerator®.
- The products are not available in all markets, please contact your Dornbracht sales force.
- For more information go to [www.insinkerator.com](http://www.insinkerator.com)

		Euro
polished chrome	10 714 970-00	91,10
platinum matt	10 714 970-06	136,60

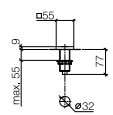

82 437 970



## Integrated washing-up liquid dispenser with rosette

- 500 ml bottle
- can be filled from the top

		Euro
polished chrome	82 437 970-00	308,60
platinum matt	82 437 970-06	462,80

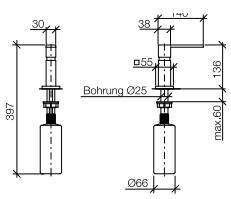

82 427 970



## Integrated washing-up liquid dispenser without rosette

- 500 ml bottle
- can be filled from the top

		Euro
polished chrome	82 427 970-00	266,20
platinum matt	82 427 970-06	399,30

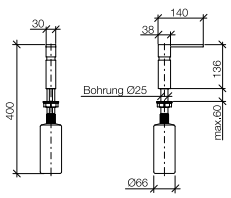

82 438 970

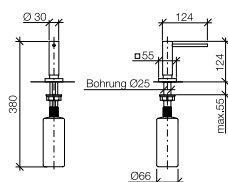
**Integrated washing-up liquid dispenser with rosette**

- 500 ml bottle
- can be filled from the top
- rotating pump head

		Euro
polished chrome	82 438 970-00	228,50
platinum matt	82 438 970-06	342,50

82 436 970

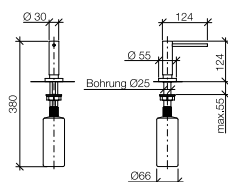
**Integrated washing-up liquid dispenser with rosette**

- 500 ml bottle
- can be filled from the top
- rotating pump head

		Euro
polished chrome	82 436 970-00	199,80
platinum matt	82 436 970-06	299,60
cyprum	82 436 970-49	399,50

82 426 970

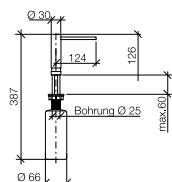
**Integrated washing-up liquid dispenser without rosette**

- 500 ml bottle
- can be filled from the top
- rotating pump head

		Euro
polished chrome	82 426 970-00	183,40
platinum matt	82 426 970-06	275,10

# Generic miscellaneous

82 435 970

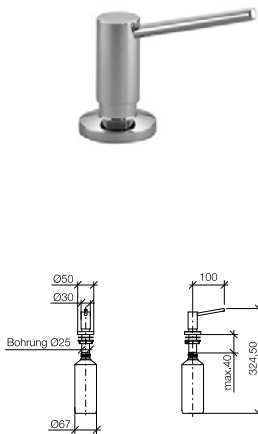

**Integrated washing-up liquid dispenser with rosette**

- 500 ml bottle
- can be filled from the top
- rotating pump head

		Euro
polished chrome	82 435 970-00	148,50
platinum matt	82 435 970-06	222,90

27 714 970



**Rinsing spray set**

- automatic spout/shower diverter
- fabric braided hose 1500 mm
- sprayface with anti-scaling system
- lead-free

for combining with the fittings of the MARO and LOT series

Intrinsic protection against back flow.

		Euro
polished chrome	27 714 970-00	396,10
platinum matt	27 714 970-06	594,20

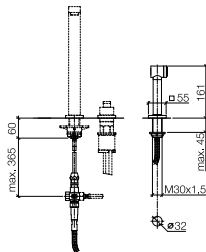

27 719 970



**Rinsing spray set**

- automatic spout/shower diverter
- fabric braided hose 1500 mm
- sprayface with anti-scaling system
- lead-free

for combining with the fittings of the TARA ULTRA, ELIO and META 02 series

Intrinsic protection against back flow.

		Euro
polished chrome	27 719 970-00	365,20
platinum matt	27 719 970-06	547,90

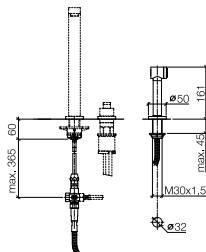

27 718 970



**Rinsing spray set**

- automatic spout/shower diverter
- fabric braided hose 1500 mm
- sprayface with anti-scaling system
- lead-free

for combining with the fittings of the TARA CLASSIC and TARA series

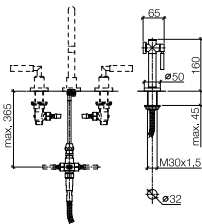

		Euro
polished chrome	27 718 970-00	381,90
platinum matt	27 718 970-06	572,80
cyprum	27 718 970-49	763,80

27 784 970



**Profi spray set**

- automatic spout/shower diverter
- alternatively for use with or without rosette
- sprayface with anti-scaling system
- lead-free

for combining with the fittings of the MARO and LOT series

Intrinsic protection against back flow.

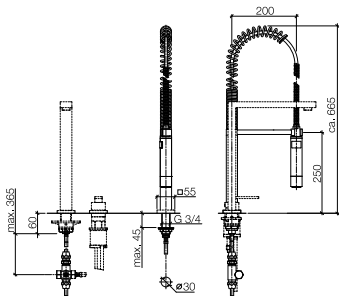

		Euro
polished chrome	27 784 970-00	944,50
platinum matt	27 784 970-06	1.417,10

27 789 970



**Profi spray set**

- automatic diverter for spout/Profi spray set
- alternatively for use with or without rosette
- sprayface with anti-scaling system
- lead-free

for combining with the fittings of the TARA ULTRA, ELIO and META 02 series

Intrinsic protection against back flow.

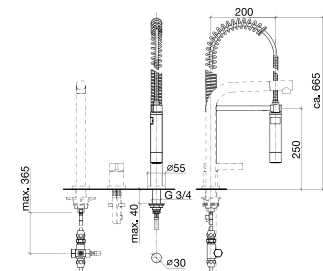

		Euro
polished chrome	27 789 970-00	891,60
platinum matt	27 789 970-06	1.337,20

# Generic miscellaneous

27 780 970



## Profi spray set

- automatic spout/shower diverter
- sprayface with anti-scaling system
- lead-free

for combining with the fittings of the TARA CLASSIC and TARA series

Intrinsic protection against back flow.

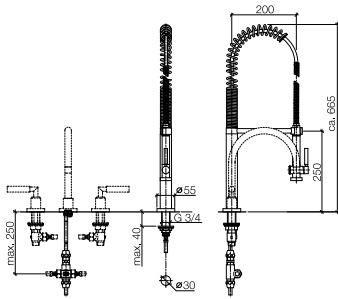

		Euro
polished chrome	27 780 970-00	817,60
platinum matt	27 780 970-06	1.226,40

12 715 970

## Cover for tap hole



		Euro
polished chrome	12 715 970-00	28,80
platinum matt	12 715 970-06	46,10

84 710 000

## DRINKING PLATE

- Plastic 117 x 117 x 40 mm
- For placing in the sink (38 001 000-86 / 38 000 000-86)
- Grid element (chrome)



		Euro
black	84 710 000-13	148,50

04 31 20 067 00

## Plug, closable by hand

- 3 1/2" lockable strainer basket valve (without control)



		Euro
matt high-grade steel	04 31 20 067 00-86	24,50

12 995 970 90

## D-CARE care set

consisting of

CLEAN Fittings cleaner 250 ml  
CARE Fittings care product 250 ml  
SHINE Fittings care cloth  
Care instructions

### NOTE:

CLEAN contains citric acid and is not suitable for acid-sensitive surfaces, such as marble!



		Euro
	12 995 970 90	68,00

# Concealed articles



# Concealed articles

35 086 970 90

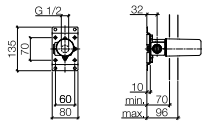
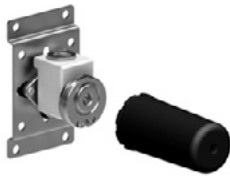

## POT FILLER concealed wall elbow

- **Concealed rough parts**
- female thread 1/2" connections
- 1x female thread 1/2" outlet
- Twist protection
- attachment set
- anti-water packing
- integrated silencer

		Euro
Concealed rough parts	35 086 970 90	82,80

35 806 970 90

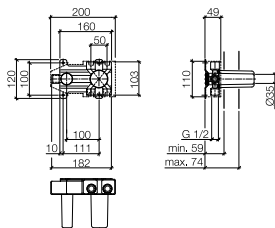
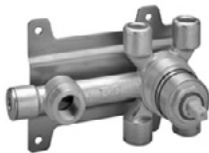

## Wall-mounted single-lever sink mixer, mixer on right

- **Concealed rough parts**
- concealed body, red brass body
- 2x female thread 1/2" connections (cold/hot)
- 1x female thread 1/2" outlet for wall spout
- cartridge with ceramic discs
- mounting plate with set of screws
- polystyrene block
- dust cover
- integrated silencer
- gauge 100 mm

		Euro
Concealed rough parts	35 806 970 90	225,40

35 807 970 90

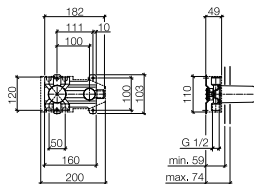

## Wall-mounted single-lever sink mixer, mixer on left

- **Concealed rough parts**
- concealed body, red brass body
- 2x female thread 1/2" connections (cold/hot)
- 1x female thread 1/2" outlet for wall spout
- cartridge with ceramic discs
- mounting plate with set of screws
- polystyrene block
- dust cover
- integrated silencer
- gauge 100 mm

		Euro
Concealed rough parts	35 807 970 90	225,40

35 808 970 90

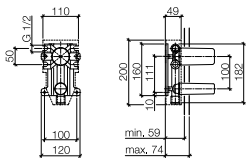

**Wall-mounted single-lever sink mixer, mixer at top**

**Concealed rough parts**

- concealed body, red brass body
- 2x female thread 1/2" connections (cold/hot)
- 1x female thread 1/2" outlet for wall spout
- cartridge with ceramic discs
- mounting plate with set of screws
- polystyrene block
- dust cover
- integrated silencer
- gauge 100 mm

Euro		
Concealed rough parts	35 808 970 90	225,40

12 070 970 90



**Extension, 20 mm**

for wall-mounted mixers 35 806 / 807 / 808 970 90

Euro		
	12 070 970 90	142,20

12 071 970

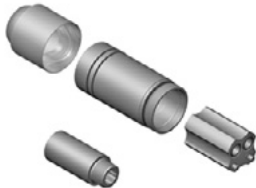

**Extension, 50 mm**

for wall-mounted mixers 35 806 / 807 / 808 970 90

Euro		
polished chrome	12 071 970-00	160,90
platinum matt	12 071 970-06	286,30

# Concealed articles

35 816 970 90



## Wall-mounted mixer, mixer on right

### Concealed rough parts

- 2x female thread 1/2" connections (cold/hot)
- 2x 1/2" x 500 mm high pressure hose
- 1x female thread 1/2" outlet for wall spout
- cartridge with ceramic discs
- gauge 100 mm

Recommended combination for this fitting:

Rear walls with

- wall thickness: 12-16 mm
- spout hole diameter: 40 mm
- mixer hole diameter: 58 mm
- clear width behind wall: 25 mm

### NOTE:

**Not suitable for concealed installation.**  
**Connection by means of angle valves,**  
**mounted with screws to back wall.**

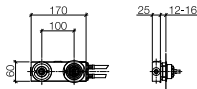

		Euro
Concealed rough parts	35 816 970 90	257,90

35 707 970 90



## Wall-mounted sink mixer

### Concealed rough parts

- 2x female thread 1/2" connections
- 1x female thread 1/2" outlet
- 3x sealing plug 1/2"
- retaining screws
- 3x dust cover
- gauge 100 mm
- concealed body, red brass

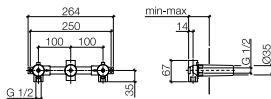

		Euro
Concealed rough parts	35 707 970 90	223,30

35 713 970 90



## Wall-mounted sink mixer, spout on left

### Concealed rough parts

- concealed body, red brass body
- 2x female thread 1/2" connections
- 3x female thread 1/2" outlet
- 3x sealing plug 1/2"
- retaining screws
- polystyrene block
- 3x dust cover
- gauge 100 mm

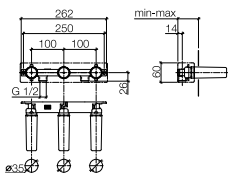

		Euro
Concealed rough parts	35 713 970 90	223,30



### Concealed rough parts

- concealed body, red brass body
- 2x female thread 1/2" connections
- 3x female thread 1/2" outlet
- 3x stud cover
- 3x sealing plug 1/2"
- retaining screws
- polystyrene block
- gauge 100 mm

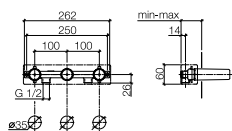

35 714 970 90

Euro

223,30

### Concealed rough parts

- 3x concealed body, red brass body
- 3x sealing plug 1/2"
- 3x dust cover

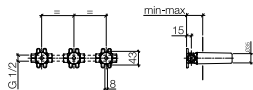

35 712 970 90

Euro

197,10



# General information

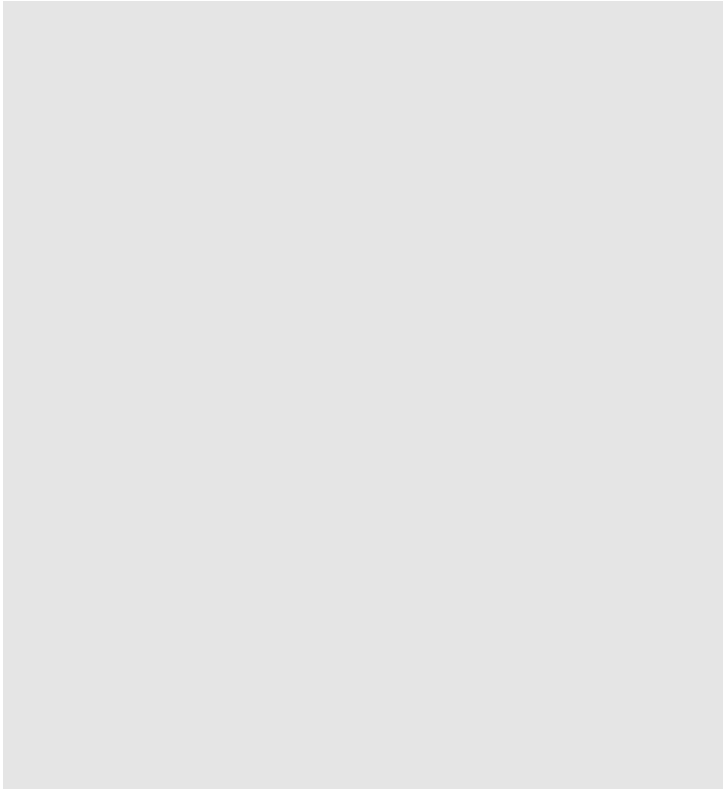

## Customisation of your Dornbracht fittings and accessories

From its very inception, Dornbracht, the fittings manufacturer, has never been a fittings manufacturer in the conventional sense. Our history now extends for over 60 years, during which we have abandoned the conventional routes time and again and have established ourselves with the reputation of a specialist for high quality and, above all, individual fittings and accessories for the bathroom and kitchen. With each of our fittings we also document our fascination for perfect manufacturing work. We use traditional craftsmanship as the basis for the very highest quality possible today – a combination of function, form and quality production for every single product design. Work at Dornbracht is not so much a matter of mechanics, but more a matter of mental or even emotional qualities. Every individual employee must be in love with every single one of our fittings, because that is the only way we can explain their great attention to detail and their continuous search for an even more perfect solution, that is a particular characteristic of our x-TRA SERVICE department. Many clever, precisely coordinated steps result in the aforementioned products that our customers expect from us.

## Special production

If, when the kitchen is being planned, it emerges that the size of a fitting or an accessory is not a perfect fit for the architecture, our x-TRA SERVICE can make extensions and reductions, provided this is technically feasible.

## Special finishes

Even if a certain finish is not listed in the catalogue for a Dornbracht fitting, the x-TRA SERVICE can refine every series in every finish and colour featured in the latest Dornbracht programme. Additional finishes and colours can be implemented on request, if production proves viable.

## Surface finishing

To ensure that even the products not supplied by Dornbracht match the chosen fitting in the kitchen, the x-TRA SERVICE provides a finish refinement service. These products are then given the same finish as the fitting from the current product programme. This service is often also used for renovating kitchens using existing fitting elements.

## Maintaining the value

To maintain our customers' pleasure in their Dornbracht classics for as long as possible, the x-TRA SERVICE offers the complete restoration of function and individual finishing for fittings which are no longer available, up to ten years after the series has been discontinued. For example, if the finish is dull and scratched, it will be ground, polished and galvanised until it gleams as good as new.

## eCustomizing

The digital solutions offer a wide range of possibilities to realise your individual requirements. A personal shower system or arranging your bath, spa and kitchen fittings in a special way – there are so many possibilities. We would be very happy to examine your request and compile a customised quote.



# Services

---

## **Sales team**

Personal advice and guidance on all commercial matters.  
Intensive support covering every aspect of selling.

Tel. +49 (0) 2371 433-460    Fax +49 (0) 2371 433-135  
Fax +49 (0) 2371 433-5506  
Fax +49 (0) 2371 433-5507  
E-Mail [mail@dornbracht.de](mailto:mail@dornbracht.de)

---

## **x-tra Service**

Individual made-to-order productions and special finishes to suit your need.

Tel. +49 (0) 2371 433-460    E-Mail [mail@dornbracht.de](mailto:mail@dornbracht.de)

---

## **Spare part service**

Tel. +49 (0) 2371 433-460    E-Mail [mail@dornbracht.de](mailto:mail@dornbracht.de)

---

You can contact our Service Centre from Monday to Thursday between 07:00 to 18:00 and on Fridays between 07:00 and 15:30.

# Terms and Conditions of Sale, Delivery and Payment

## 1. General

**1.1.** The following terms apply exclusively to all our quotations, sales and deliveries both now and in the future. We do not accept purchasers' terms of business which conflict with or differ from our Terms and Conditions unless we have expressly agreed to them in writing. This also applies in cases where we execute in the knowledge of the conflicting or differing Terms and Conditions of the purchaser or a third party delivery to the purchaser unconditionally or refer to a letter or document of the purchaser containing conflicting or differing Terms and Conditions of the latter or of a third party or refer to them without objecting to the Terms and Conditions concerned. Differing arrangements apply only to a specific contract and not to subsequent contracts, save where expressly otherwise agreed.

**1.2.** All agreements, subsidiary agreements and contractual amendments must be made in writing. To be effective, verbal or written agreements deviating from our contractual conditions and/or the order confirmation must be approved by the proper number of directors or authorised officers. Our office staff or field staff are not authorised to make differing agreements or grant special conditions.

## 2. Information, advice

Information and advice given on our products are based on our previous experience. The figures quoted are average values found. Information and advice do not obviate the need for acceptance tests on goods supplied or compliance with processing instructions. Information given verbally is not binding.

## 3. Quotation, contract signature

**3.1.** Our quotations are made without engagement. A supply contract or other contract becomes binding on us only when we have confirmed the customer's order or other order in writing or have delivered the goods.

**3.2.** Samples and specimens are supplied without engagement for inspection purposes. A purchase according to sample and/or specimen is subject to commercially acceptable deviations or those falling within normal manufacturing tolerances. Unless expressly specified in the order confirmation, the supply of patterns or samples does not constitute a guarantee of quality or service life.

**3.3.** Samples and specimens must be returned to us in perfect condition within 4 weeks. If they are not returned within this period we shall be entitled to charge the list purchase price. Price lists are available on request at any time.

**3.4.** Save where expressly otherwise agreed, the information provided by us in text or illustrated form (e.g. descriptions, illustrations or drawings) in catalogues, brochures or other publications conclusively define the quality of the goods we supply and their potential applications. The information we provide is not a guarantee of service life or quality and corresponds to our current state of knowledge. We accept no liability for successful use.

## 4. Prices

**4.1.** All prices agreed are net exclusive of VAT, which the purchaser must pay at the relevant statutory rate.

**4.2.** A minimum quantity surcharge of € 5.00 will be made on orders with a net merchandise value of under € 50.00.

**4.3.** If there is any increase in our sundry material procurement costs, energy costs or labour costs/incidental wage costs between the date of order confirmation and the date of delivery, we shall be entitled to adjust the agreed price accordingly. The purchaser will be entitled to cancel the contract with immediate effect if the price rise exceeds 5 %, but no later than within 10 days of the price increase becoming known to purchaser.

## 5. Delivery

**5.1.** The delivery periods will begin on the date of our order confirmation, but not before any agreed down payment has been received, all of the purchaser's other obligations have been duly and punctually fulfilled and not before all the order details have been finally clarified, the requisite certificates procured and/or all necessary documents provided. The delivery period

is deemed to have been met if the goods have left our factory or warehouse before this period has expired, or have been notified as ready for delivery but cannot then be forwarded on time for reasons beyond our control. Delivery dates are deemed to be approximate where there is no provision to the contrary and do not constitute a fixed transaction without a specific agreement to this effect. The purchaser is to inform us no later than at the time of conclusion of contract of any contractual default penalties that may be due vis-à-vis his customer in case of late delivery. Without such prior notification, the purchaser may not assert vis-à-vis us any claims arising from contractual default penalties he may incur.

**5.2.** When a delivery date not expressly designated as „fixed“ in the order confirmation is overrun, the purchaser may set a reasonable extension period for delivery. We can only be in default on expiry of this extension period.

**5.3.** Without prejudice to our rights arising from delays in payment by the purchaser, delivery dates will be extended by the period of time that the purchaser fails to honour his obligations towards us.

**5.4.** We reserve the right to make proper and timely self-supply if irregular self-supply is beyond our control.

**5.5.** Unforeseen, exceptional circumstances beyond our control such as strikes, lock-outs and other industrial action, operational breakdown e.g. due to fire and similar occurrences, difficulties in the sourcing of materials and energy, lack of labour resources, energy and raw materials, government action, transport disruption, difficulties in the obtaining of permits with specific regard to import and export licences or other instances of force majeure beyond our control and area of influence, irrespective of whether we or our suppliers are affected by such circumstances or whether they occur during an ongoing delay, the period of delivery is to be extended by the duration of the disruption in addition to a reasonable start-up period. Should the delay/disruption not be of a temporary nature and should delivery subsequently become impossible or compliance with the contract unreasonable for one party as a result, either party will be entitled to terminate the contract. Claims for compensation are excluded in such cases where neither party is to blame.

**5.6.** Our liability for loss due to delay arising from slightly negligent breach of duty is excluded, save where the breach of duty results in damage to life, limb or health. A change in the burden of proof to the disadvantage of the purchaser has no connection with this provision.

**5.7.** Should liability for loss due to delay arise not only from slightly negligent breach of duty, the purchaser may, insofar as he proves the existence of damage due to delay and subject to the exclusion of further claims, only claim compensation amounting to 0.5 % for each full week of delay, up to a maximum of 5 % in total, of the value of that part of the total delivery which owing to the delay could not be used on time or for its contractual purpose.

**5.8.** We shall be entitled to make part deliveries where acceptable to the purchaser. Part deliveries may be invoiced separately.

## 6. Forwarding, passage of risk

**6.1.** Delivery will be ex works (Iserlohn) unless otherwise agreed. If Incoterms have been agreed as delivery terms, the version applicable on the date of contract signature shall apply.

**6.2.** If at the purchaser's request the goods have been forwarded to a place other than the place of performance, the purchaser will meet all the costs thereby incurred. The choice of transit route and carrier will be at our discretion. We and the carrier must be notified in writing by the purchaser of the type and extent of any transit damage immediately on receipt of the goods. Goods will only be insured against damage, loss or breakage in transit at the purchaser's express request and at his expense.

**6.3.** Forwarding and transportation are always at the purchaser's risk when goods are supplied ex works. This is also applicable if we make delivery to a third party (drop shipment deliveries) and when goods or empties (reusable packaging) are returned. Even when part deliveries are made, the risk will pass to the purchaser as soon as the consignment has been transferred to the carrier or has left our warehouse for forwarding or, in the case of delivery ex works, has left our plant.

**6.4.** For drop shipment deliveries we add a surcharge of 10% on the net value of the goods.

**6.5.** If forwarding is delayed due to circumstances for which the purchaser is responsible, or if the purchaser himself is arranging transportation, the risk will pass to the purchaser on notification that the goods are ready for dispatch. The purchaser must meet storage charges incurred after the passage of risk. The monthly storage charge for goods stored to our factory or warehouse will be 0.5% of the invoiced amount. We reserve the right to make higher storage charges subject to proof. Once a reasonable period of time has elapsed to no effect, we shall be entitled to otherwise dispose of the goods and to supply the purchaser within a reasonably extended period.

## 7. Payment

**7.1.** Payment must be made in Euro (€) and must be free of charges and postage. It must be remitted only to the bank indicated by us. Checks will only be valid as payment after encashment and are accepted without obligation for due presentation and protestation.

**7.2.** Unless expressly otherwise agreed, invoices must be paid within 10 days of the invoice date at a 2 % discount and within 30 days of the invoice date with no deduction. There will be no discount entitlement if previous outstanding invoices remain unpaid.

**7.3.** When the period allowed for payment has been exceeded we shall be entitled to charge interest at 8 % p.a. above the basic interest rate (Section 247 of the German Civil Code [BGB]). All our outstanding accounts will also become due immediately.

**7.4.** The offsetting of any counterclaims by the purchaser is permissible only if such counterclaims are undisputed or established in law. The purchaser may at most withhold a sum amounting to three times the cost of subsequent performance due to deficiency. When exercising his right of retention the purchaser agrees to pay us security of our choice to the amount of the unpaid portion by bank guarantee or by depositing it with a notary of his choosing, whichever we choose.

## 8. Reservation of title

**8.1.** All goods delivered shall remain our property (reserved-title goods) pending settlement of all outstanding accounts on any legal grounds whatsoever, including all future and conditional claims arising from contracts signed simultaneously or subsequently. The same shall apply if payments are made on specially designated accounts outstanding. Should there be justifiable grounds for assuming that a purchaser is unable to pay or that such inability is impending, we shall be entitled to terminate the contract without notice and to demand restitution of the goods.

**8.2.** Reserved-title goods are manufactured and processed on our behalf as manufacturers in accordance with Section 950 BGB without incurring any obligation on our part. Processed goods are deemed to be reserved-title goods as defined in para. 8.1. If the reserved-title goods are processed, interconnected, mingled or mixed with supplied goods by the purchaser, we shall be entitled to co-ownership of the new goods to the ratio of the invoice value of the reserved-title goods. Should our title cease as a result of the combination or inclusion, the purchaser agrees with immediate effect to assign to us his title or expectant rights in the new goods or object to the extent of the invoice value of the reserved-title goods and to retain same on our behalf at no charge. The co-ownership rights at issue shall be deemed to be reserved-title goods as defined in para. 8.1.

**8.3.** The purchaser may sell on, process or combine the reserved-title goods with other items or otherwise install them (resale) only as part of his normal business operations and as long as he is not in default. He shall not be entitled to dispose of the reserved-title goods in any other manner. We must be informed immediately of any third party seizure or other access to the reserved-title goods.

**8.4.** The purchaser agrees with immediate effect to assign to us his claims arising from the resale of the reserved-title goods. These rights shall be considered as security to the same extent as the reserved-title goods. The purchaser will only be entitled and authorised to resell on the assurance that the claims thereby owed him are transferred to us.

**8.5.** If the reserved-title goods are sold by the purchaser at an inclusive price together with third-party

goods, the claims arising from the sale shall be assigned to us in the same ratio as the invoice value of our reserved-title goods sold in each case.

**8.6.** If the claim assigned is included in a current account, the purchaser hereby assigns to us a part of the balance corresponding to the amount of this claim inclusive of the final balance from the current account.

**8.7.** The purchaser will be entitled to collect the claim assigned us until such time as we revoke. We shall be entitled to revoke if the purchaser fails to meet his payment obligations arising from the business transactions with us or if we become aware of circumstances likely to substantially lessen the purchaser's credit worthiness. If the conditions are such that we wish to exercise our right to revoke, the purchaser must on request inform us forthwith of the claims assigned and the debtors thereof, provide all the information necessary to collect the debt, hand over the associated documents to us and notify the debtor of the assignment. The buyer is not authorised to assign any claims, not even on the basis of our direct debit authorisation.

**8.8.** Should the realizable value (invoice amount of goods or nominal amount of the receivables) exceed 50% of the securities existing for us, we are obliged to release securities of our own choice upon the purchaser's demand.

**8.9.** Our assertion of reservation of title shall not constitute revocation of the contract unless we expressly state this in writing. The purchaser's right to own the reserved-title goods shall lapse if he fails to perform his obligations under this or any other contract.

## **9. Liability for faulty goods**

**9.1.** We do not accept liability for unsuitable or improper use, particularly excessive loading, faulty assembly or faulty operation by the purchaser or third parties, natural wear and tear, faulty or negligent usage or handling, particularly by untrained staff.

**9.2.** The purchaser agrees to inspect deliveries carefully for completeness and adequacy immediately on receipt – even if patterns or samples were previously supplied. The delivery is deemed to have been accepted if a deficiency has not been reported to us by letter, telex or fax within 10 working days of the goods arriving at their destination, or, if the deficiency could not be found during proper inspection, within 10 working days of discovering same. This also applies to multiple deliveries. A multiple delivery is deemed to have been accepted if no complaint is lodged within 10 days of the goods arriving at their destination. Our field staff are not authorised to acknowledge quantity or deficiency complaints.

**9.3.** A purchaser accepting faulty goods knowing them to be defective shall only be entitled to the claims and rights in respect of deficiencies if he reserves the right to these by reason of deficiency on acceptance.

**9.4.** We guarantee to meet the purchaser's claims for defective goods for a period of two years, starting with the date of each delivery. This will not affect liability for defects in title under statutory regulations. The liability for losses contingent on defects shall be governed by para. 10.

**9.5.** Where there are grounds for complaint, the purchaser will initially only have a claim to subsequent performance which we may effect as we deem fit, either by repair or by supplying a defect-free item. If subsequent performance fails or is unacceptable or dispensable to the purchaser (Section 440 BGB), the purchaser will have the right to reduce the purchase price or, if he so chooses, to revoke the contract or to demand damages in place of performance or reimbursement of wasted expenditure in accordance with para. 10 because

- a) we finally refuse subsequent performance,
- b) we do not effect subsequent performance on a contractually agreed date or within a specific period and in the contract the purchaser has bound the continuance of his interest in performance to the timely delivery of performance,
- c) there are special circumstances which justify intermediate cancellation on a consideration of the interests of both parties (Section 323 para. 2 BGB).

**9.6.** Where we deem it necessary to effect repairs or replacement deliveries, the purchaser shall allow us sufficient time and opportunity for such repairs or

replacement deliveries, otherwise our liability for the deficiency shall be deemed to have been discharged. Only in urgent cases of risk to operating safety or to avert considerable damage, in which case we must be informed immediately, or when we are late in rectifying the defect shall the purchaser have the right to remedy the defect himself or have it remedied by a third party and to demand compensation of the requisite cost from us.

## **10. Liability for damages**

**10.1.** We accept liability for damages arising from injury to life, limb or health and in accordance with the Product Liability Act pursuant to the relevant statutory provisions.

**10.2.** Our liability for breach of duty and our non-contractual liability shall, moreover, be limited to malicious intent and gross negligence. Liability for gross negligence by our non-senior employees, staff and vicarious agents is hereby limited to the level of contractually typical, foreseeable damage, the occurrence of which we could have expected at the time of conclusion of contract on the basis of the circumstances known to us at the given time to the exclusion of damage not incurred directly by the object of delivery such as and above all the lack of economic success, lost profit, indirect damage, consequential damage due to a given defect and third-party claims.

**10.3.** The above limitation of liability pursuant to para. 10.2. does not apply to the breach of duties material to contract (cardinal duties). The latter are those duties compliance with which permits proper and due fulfillment of contract at all and in the compliance with which the contracting party trusts and is entitled to trust. In this case, even in the event of slight negligence, we shall be liable for our own negligence and that of our employees, staff or vicarious agents, limited however to the level of contractually typical, foreseeable damage, the occurrence of which we could have expected at the time of conclusion of contract on the basis of the circumstances known to us at the given time.

**10.4.** The above limitations on liability apply equally to claims for the reimbursement of wasted expenditure (Section 284 BGB).

**10.5.** Claims against us for damages on any legal grounds whatsoever shall become statute-barred within two years of the statutory commencement of the limitation period.

**10.6.** A shift in the burden of proof to the disadvantage of the purchaser is not connected with the above provisions.

## **11. Returned goods**

The reconsignment of goods sold or the reversal of the contract are only admissible in exceptional cases and upon our explicit prior consent, except in the cases stated in these Terms and Conditions. Goods sent back without our consent will be rejected, respectively returned to the Buyer freight forward. Reconsigned goods as described above always go at the Buyer's risk and account. When reimbursing the value of reconsigned goods, we will charge handling expenses amounting to 25% of the net value of the goods and make deductions according to the usability of the goods.

## **12. Data Protection / Confidentiality Agreement**

**12.1.** We process and use personal data under consideration of applicable data protection law. The processing and use is effected for the purpose of fulfillment of our services rendered to the purchaser. In this context it might be necessary to transfer the data to third parties, for example to the data processing center being employed by us, logisticians or collection agencies. Furthermore, an exchange of data might occur within our company group. If necessary, we will obtain the required consent for the processing of the data from the purchaser. Further information with regard to the handling of data can be gathered from our data protection policy which is available in the internet under [www.dornbracht.com](http://www.dornbracht.com). In addition, our data protection officer will be at your disposal for any questions.

**12.2.** The purchaser is obliged to keep the content of our offer / the agreement or other confidential information respectively company and business secrets in strict confidence. Those information may only be disclosed to third parties if this is legally compulsory or if

we have given our prior written consent. Information known to the purchaser prior to the receipt of our offer or publicized prior to or after conclusion of the contract without our or the purchaser's involvement are not regarded as confidential information.

## **13. Place of performance, court of jurisdiction, applicable law**

**13.1.** The place of performance for the obligations of either party under this contract shall be Iserlohn.

**13.2.** Any disputes involving registered merchants shall exclusively be settled before a competent court of law having jurisdiction for our headquarters. We shall, however, be entitled to bring an action against the purchaser at another legal place of jurisdiction.

**13.3.** The relationship between ourselves and the purchaser shall be governed by German law to the exclusion of the United Nations Convention on the International Sale of Goods (CISG) and the provisions of international patent law.

**13.4.** Should subsequent circumstances cause individual provisions of these Terms and Conditions to be or become invalid, this shall not affect the validity of the remaining provisions.

Issued December 2010





Aloys F. Dornbracht GmbH & Co. KG Armaturenfabrik  
Köbbingser Mühle 6  
D-58640 Iserlohn  
Phone +49 (0) 2371 433-460  
Fax +49 (0) 2371 433-135  
E-Mail [mail@dornbrachtgroup.de](mailto:mail@dornbrachtgroup.de)  
[www.dornbracht.com](http://www.dornbracht.com)

## Dornbracht Group

Premium Solutions for Interior Architecture

01 01 15 974 09 / 03.2015

